



***Refrigerated Topping Rails***  
*Models RS-CN-0004-P, 0005-P, 0006-P, 0009-P*  
*Items 40535, 40536, 39594, 39595*  
***Instruction Manual***



*Revised - 3/30/2015*

Toll Free: 1-800-465-0234

Fax: 905-607-0234

Email: [sales@omcan.com](mailto:sales@omcan.com)

[www.omcan.com](http://www.omcan.com)



# ***Table of Contents***

Model RS-CN-0004-P / Model RS-CN-0005-P  
Model RS-CN-0006-P / Model RS-CN-0009-P

---

<b>Section</b>	<b>Page</b>
General Information -----	3
Safety and Warranty -----	4 - 5
Technical Specifications -----	6
Installation -----	6 - 8
Operation -----	8 - 9
Maintenance -----	10
Troubleshooting -----	10 - 11
Parts Breakdowns -----	26 - 27
Electrical Schematics -----	28
Warranty Registration -----	31



# *General Information*

---

Omcan Manufacturing and Distributing Company Inc. and Food Machinery of America, Inc. dba Omcan are not responsible for any harm or injury caused due to any person's improper or negligent use of this equipment. The product shall only be operated by someone over the age of 18, of sound mind, and not under the influence of any drugs or alcohol, who has been trained in the correct operation of this machine, and is wearing authorized, proper safety clothing. Any modification to the machine voids any warranty, and may cause harm to individuals using the machine or in the vicinity of the machine while in operation.

## **CHECK PACKAGE UPON ARRIVAL**

Upon receipt of an Omcan shipment please inspect for external damage. If no damage is evident on the external packaging, open carton to ensure all ordered items are within the box, and there is no concealed damage to the machine. If the package has suffered rough handling, bumps or damage (visible or concealed), please note it on the bill of lading before accepting the delivery and contact Omcan within 24 hours, so we may initiate a claim with the carrier. A detailed report on the extent of the damage caused to the machine must be filled out within three days, from the delivery date shown in the shipping documents. Omcan has no recourse for damaged products that were shipped collect or third party.

---

# *Safety and Warranty*

---

Position on a flat, stable surface. A service agent/qualified technician should carry out installation and any repairs if required. Do not remove any components or service panels on this product. Consult Local and National Standards to comply with the following:

- Health and Safety at Work Legislation.
- Fire Precautions.
- IEE Wiring Regulations.
- Building Regulations.
  
- The appliance is intended for commercial use.
- DO NOT attempt to service the item yourself.
- DO NOT use damaged appliances. If you are in any doubt, consult Omcan.
- DO NOT use electrical appliances inside the appliance (e.g. heaters, ice-cream makers etc.), unless they are of the type recommended by the manufacturer.
- Keep ventilation openings, in the appliance enclosure or in the built-in structure, clear of obstruction.
- DO NOT use mechanical device or other means to accelerate the defrosting process, other than those recommended by the manufacturer.
- DO NOT damage the refrigerant circuit.
- DO NOT stand or support yourself on the appliance or glass panel.
- DO NOT allow oil or fat to come into contact with the plastic components. Clean immediately if contact occurs.
- DO NOT place combustion, explosive or volatile article, corrosive acid or alkali, or liquid into the unit.
- DO NOT use this appliance to store medical supplies.
- DO NOT use jet/pressure washers to clean the appliance.
- DO NOT allow children to play with the packaging, and destroy plastic bags safely.
- Always carry, store and handle the appliance in a vertical position and move by holding the base of the appliance.
- Always switch off and disconnect the power supply to the unit before cleaning.
- Keep all packaging away from children. Dispose of the packaging in accordance with the regulations of local authorities.



# Safety and Warranty

---

- If the supply cord is damaged, it must be replaced by the manufacturer, its service agent or similarly qualified persons in order to avoid a hazard.
- This appliance is not intended for use by persons (including children) with reduced physical, sensory or mental capabilities, or lack of experience and knowledge, unless they have been given supervision or instruction concerning use of the appliance by a person responsible for their safety.
- Children should be supervised to ensure that they do not play with the appliance.
- For indoor use only. Not suitable for installation in an area where a water jet could be used. Must not be cleaned by a water jet.
- To guarantee safe operation, ensure that the appliance is set up and connected as described in the instruction manual.
- Any repairs and work on the appliance should only be carried out by the customer service department.
- Do not store explosive substances such as aerosol cans with a flammable propellant in this appliance.

## 1 YEAR PARTS AND LABOUR WARRANTY

**Within the warranty period, contact Omcan Inc. at 1-800-465-0234 to schedule an Omcan authorized service technician to repair the equipment locally.**

**Unauthorized maintenance will void the warranty. Warranty covers electrical and part failures not improper use.**

### **WARNING:**

The packaging components are classified as normal solid urban waste and can therefore be disposed of without difficulty.

**In any case, for suitable recycling, we suggest disposing of the products separately (differentiated waste) according to the current norms.**

**DO NOT DISCARD ANY PACKAGING MATERIALS IN THE ENVIRONMENT!**

# Technical Specifications

Model	RS-CN-0004-P	RS-CN-0005-P	RS-CN-0006-P	RS-CN-0009-P
Rated Power Input	160W			
Rated Current	1.2A	1.3A		
Consumption	1.2 kw/h (24h)		1.3 kw/h (24h)	1.4 kw/h (24h)
Refrigerant	R134a (120g)	R134a (125g)	R134a (130g)	R134a (155g)
Rated Frequency	50Hz			
Rated Voltage	125 VAC			
Volume	45 L / 1.6 cu. ft.	50 L / 1.8 cu. ft.	60 L / 2.1 cu. ft.	70 L / 2.5 cu. ft.
Temperature	2-10°C / 35.6-50°F			
Foaming Agent	CP/IP			
Net Weight	45 kg. / 99.2 lbs.	52 kg. / 114.6 lbs.	55 kg. / 121.3 lbs.	65 kg. / 143.3 lbs.
Dimensions	1200 x 395 x 225 mm	1400x 395 x 225 mm	1500 x 395 x 225 mm	2000 x 395 x 225 mm
	47.2" x 15.6" x 8.9"	55.1" x 15.6" x 8.9"	59" x 15.6" x 8.9"	78.7" x 15.6" x 8.9"
Protection Class	I			
Noise	56dB			

## Installation

1. Remove the appliance from the packaging. Make sure that all protective plastic film and coatings are thoroughly removed from all surfaces. To prevent injury or damage to the unit, the appliance should be unpacked and set up by two people.
2. Maintain a distance of 20cm (7 inches) between the unit and walls or other objects for ventilation. Increase this distance if the obstacle is a heat source.
3. Level the appliance by adjusting the screw feet. It should be placed on the level solid surface to reduce the vibration and noise.
4. The ambient temperature must be between 10-32°C/50-89.6°F (Climatic Class 4). Avoid locating it in direct sunlight or near heat source such as an oven or a radiator.
5. Please make sure the appliance is properly ventilated.
6. Power supply and voltage at the operating point that complies with the details on the rating label. The plug must be accessible after installation.
7. Correctly connect and disconnect the plug. When insert the plug, it must be plugged tightly when pulling out the plug, the plug should be held by hand. Never pull the supply cord directly.
8. If the showcase is to be shut down for long period, switch it off and disconnect the plug from socket outlet. Clean the appliance and leave the lid open to prevent odor.
9. Important! For your personal safety, this appliance must be properly grounded. This appliance is equipped

# Installation

with a cord having a grounding wire with a grounding plug. The plug must be inserted into an outlet that is properly grounded and installed. Consult a qualified electrician or service center if you do not completely understand the grounding instructions. If doubt exists as to whether the appliance is properly grounded, have a qualified electrician check the circuit to make sure the outlet is properly grounded.

10. If the cable does not reach the nearest socket, either rearrange your store layout or ask a qualified electrician to fix a new socket. Do not use an extension cord.
11. If power is cut off, wait for at least 3 minutes before restart the unit to avoid damaging the compressor.

## INSTALLATION OF FIT GLASS PANELS

**ATTENTION: RISK OF BREAK WITH THE GLASS PANEL.**

**Note: Ensure the hole in the collar for the grub screw faces inwards.**

**Note: Ensure the screw hole furthest from the edge of the panel goes to the back of the appliance.**

**Note: Ensure the soft end of the grub screw is the end making contact with the glass.**

**Note: Ensure the short end of the bolt assembly is on the outside of the panels.**

**Note: The glass panel must not be used as shelf.**

1. Unpack the wooden/carton box carefully; it's recommended to do this work with two people.
2. Screw the collars to the rim of the appliance.
3. Slot the two side panels into the collars, with the holes in the glass at the top.
4. Screw a grub screw into each collar to secure the panels.
5. Slot the rear panel into the collars, with the holes in the glass at the top.
6. Screw a grub screw into each collar to secure the panel.
7. Slot the plastic bushes into each of the holes.
8. Screw the brackets to the inside of each panel using the bolt assemblies.
9. Place the top panel onto the brackets, ensuring all holes line up.
10. Insert the bush and attach the top panel to the brackets with the bolt assemblies.

## GLASS PANEL ASSEMBLY GUIDE

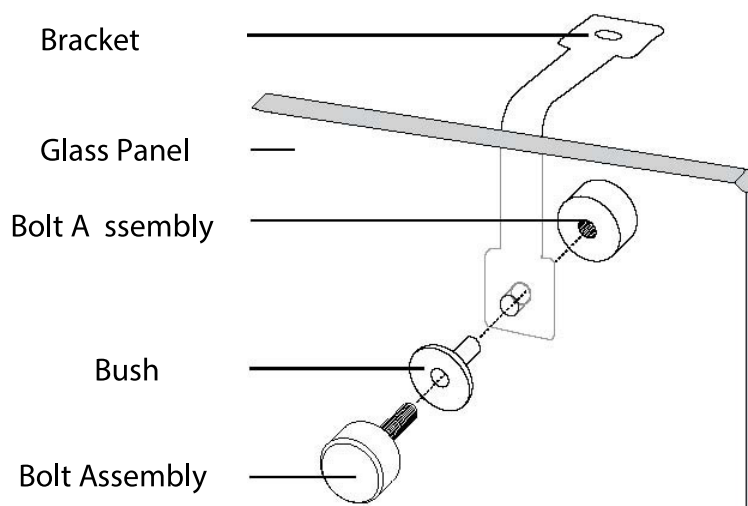

# Installation

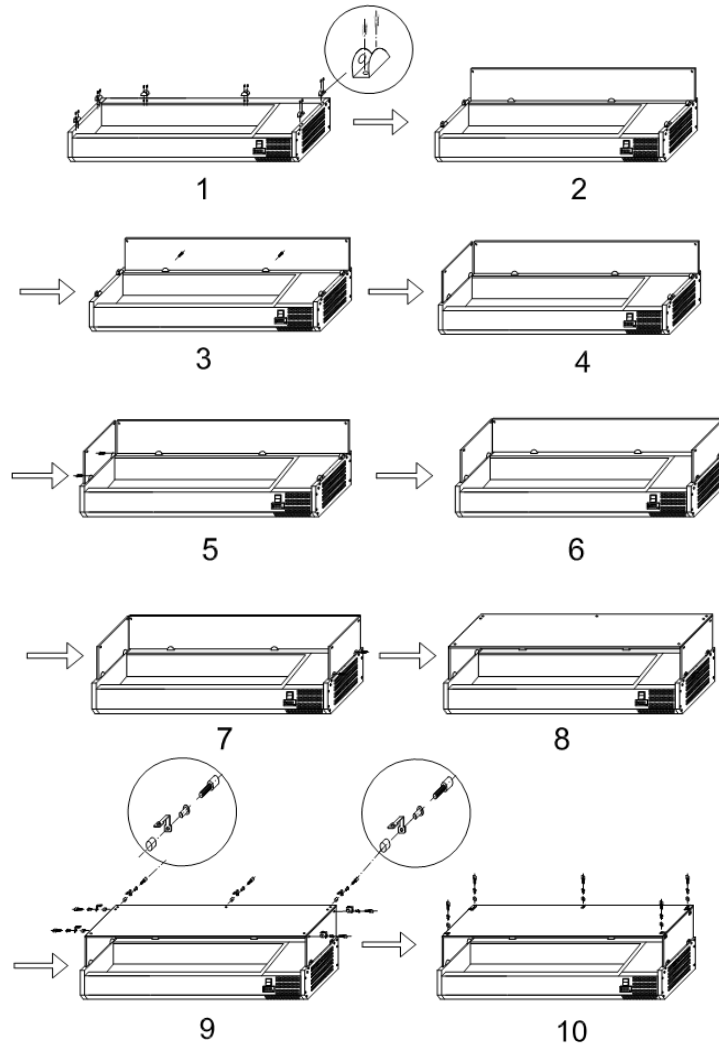

# Operation

## STORING FOOD

To get the best results from your appliance, follow these instructions: Only store foodstuffs in the appliance when it has reached the correct operating temperature. Ensure GN container bays are full at all times, even if the GN containers are unused or empty. Empty bays will greatly reduce efficiency of the appliance.

## TURN ON

1. Ensure the power switch is set to [O] and turn on at the socket.



2. Switch on the Power [I]. The current temperature within the appliance is displayed.
3. The ❄️ on the control panel flash for 3 min for anti-short cycle delay between the motor compressor stop and the following restart.

## TEMPERATURE SETTING AND CONTROL

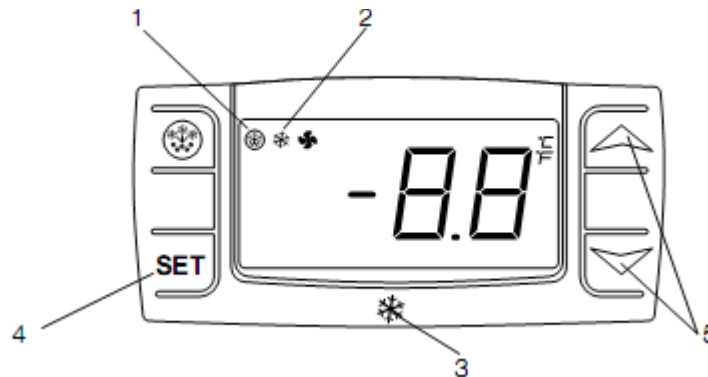

1. Defrosting light.
2. Compressor operation light.
3. Digital thermostat.
4. Programming key (service agent only).
5. Temperature modification keys.

### How to see the set point

1. Push and immediately release the SET key, the set point will be showed.
2. Push and immediately release the SET key or wait about 5s to return to normal visualization.

### How to change the set point

1. Push the SET key for more than 2 seconds to change the set point value.
2. The value of the set point will be displayed and the "°C" starts blinking.
3. To change the set value push the UP or DOWN arrows within 10s.
4. To memories the new set point value push the SET key again or waits 10s.

## MANUAL DEFROST

The appliance will automatically run a defrost cycle every 12 hours.

**Note: The cycle starts from the time the appliance is initially powered up.**

### To manually defrost the appliance:

1. Press and hold the DEFROST ❄️ button for 5 seconds.
2. The defrost cycle will start immediately and the Defrost LED illuminates. The defrost will last 20 minutes.

**Note: Starting a manual defrost also resets the automatic defrost timer. The next automatic defrost will start 12 hours after the manual defrost has finished.**

# Maintenance

---

## ROUTINE MAINTENANCE

Switch off and disconnect from the power supply before cleaning.

- Clean the enclosure and interior of the appliance as often as possible.
- Wash the unit with moist cloth. Never allow the switch, control panel, cable or plug to get wet.
- Do not use abrasive cleaning agents. These can leave harmful residues. Use only mild soapy water.
- Ensure that no cleaning water penetrates into the electrical components.
- Must not be cleaned by a water jet.
- Always wipe dry after cleaning with soft cloth.
- Take care when cleaning the rear of the appliance.
- An agent or qualified technician must carry out repairs if required.
- If the appliance is to be left inactive for long periods, unplug the appliance after having turned the switch to OFF position, empty the refrigerating compartment and clean thoroughly.

## SPECIAL MAINTENANCE

The instructions given in the following paragraph are for SKILLED PERSON.

- Periodically clean the condenser using suitable tools ( vacuum cleaner or soft brushes).
- Check that the electrical connections are not loose.
- Check that the thermostat and the sensor are in proper working order.
- Recommend that an agent or qualified technician clean the condenser.

# Troubleshooting

---

Fault	Probable Cause	Action
The appliance is not working.	The unit is not switched on.	Check the unit is plugged in correctly and switched on.
	Plug and lead are damaged.	Call your agent or qualified technician.
	Fuse in the plug has blown.	Replace the fuse (GB).
	Power supply.	Check power supply.
	Internal wiring fault.	Call your agent or qualified technician.

# Troubleshooting

The appliance turns on, but the temperature is too high / low.	Too much ice on the evaporator.	Defrost the appliance.
	Condenser blocked with dust.	Call your agent or qualified technician.
	Appliance is located near a heat source or air flow to the condenser is being interrupted.	Move the refrigerator to a more suitable location.
	Ambient temperature is too high.	Increase ventilation or move appliance to a cooler position.
	Unsuitable foodstuffs are being stored in the appliance.	Remove any excessive hot foodstuffs or blockages to the fan.
	Appliance is overloaded.	Reduce the amount of food stored in the appliance.
The appliance is unusually loud.	Loose nut/screw.	Check and tighten all nuts and screws.
	The appliance has not been installed in a level or stable position.	Check installation position and change if necessary.

# Parts Breakdown

**Model RS-CN-0004-P** 40535

**Model RS-CN-0005-P** 40536

**Model RS-CN-0006-P** 39594

**Model RS-CN-0009-P** 39595

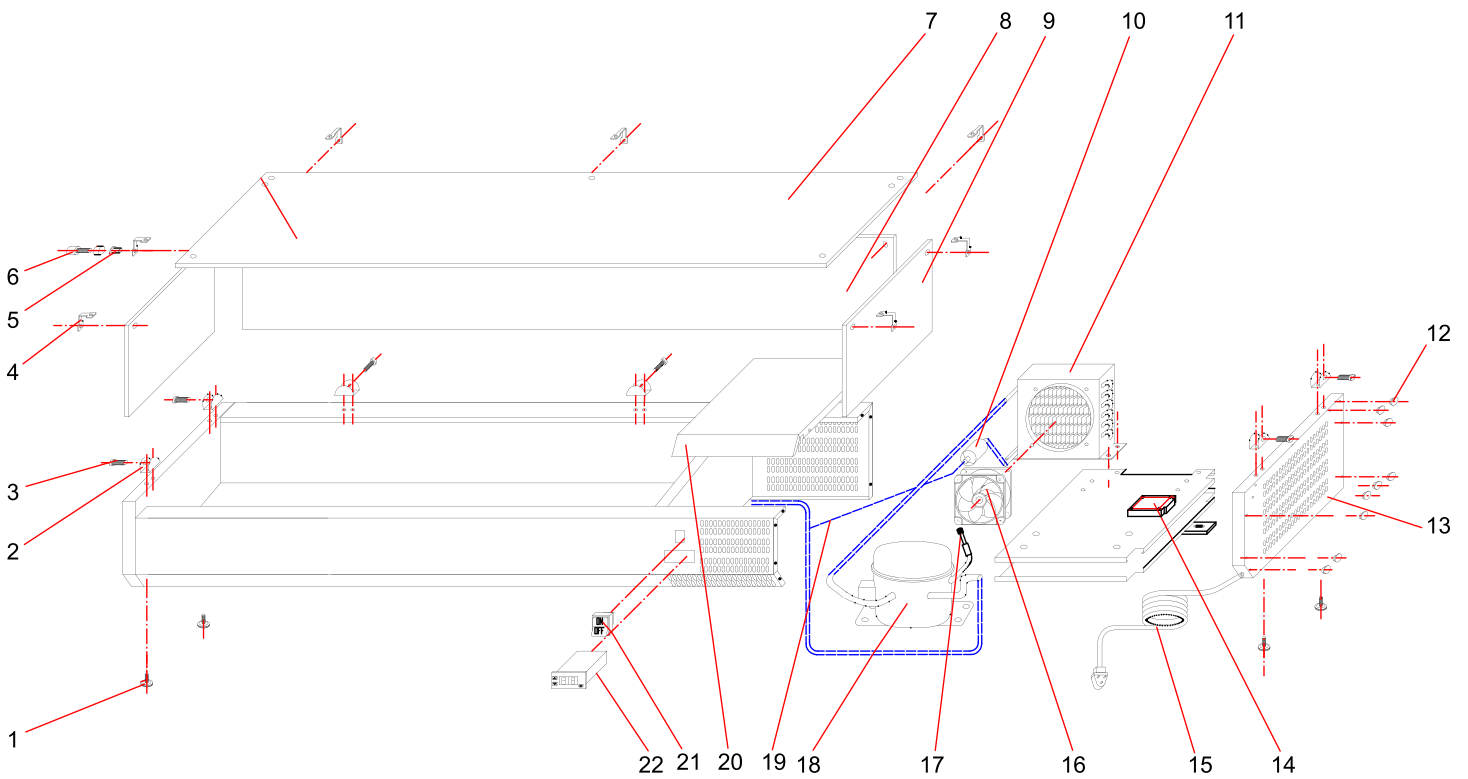

# Parts Breakdown

**Model RS-CN-0004-P** 40535

**Model RS-CN-0005-P** 40536

**Model RS-CN-0006-P** 39594

**Model RS-CN-0009-P** 39595

Description	Position	Description	Position	Description	Position
Feet	1	Side Glass	9	Charging Valve	17
Glass Fixing Clip	2	Filter Drier	10	Compressor	18
Glass Fixing Screw	3	Condenser	11	Capillary Tube	19
Glass Linking Clip	4	Plastic Cap	12	Unit Room Cover	20
Bushing	5	Side Cover	13	Main Switch	21
Glass Fixing Nut Bolt	6	Junction Box	14	Thermostat	22
Top Glass	7	Plug	15		
Back Glass	8	Condenser Fan	16		

# Electrical Schematics

**Model RS-CN-0004-P** 40535

**Model RS-CN-0005-P** 40536

**Model RS-CN-0006-P** 39594

**Model RS-CN-0009-P** 39595

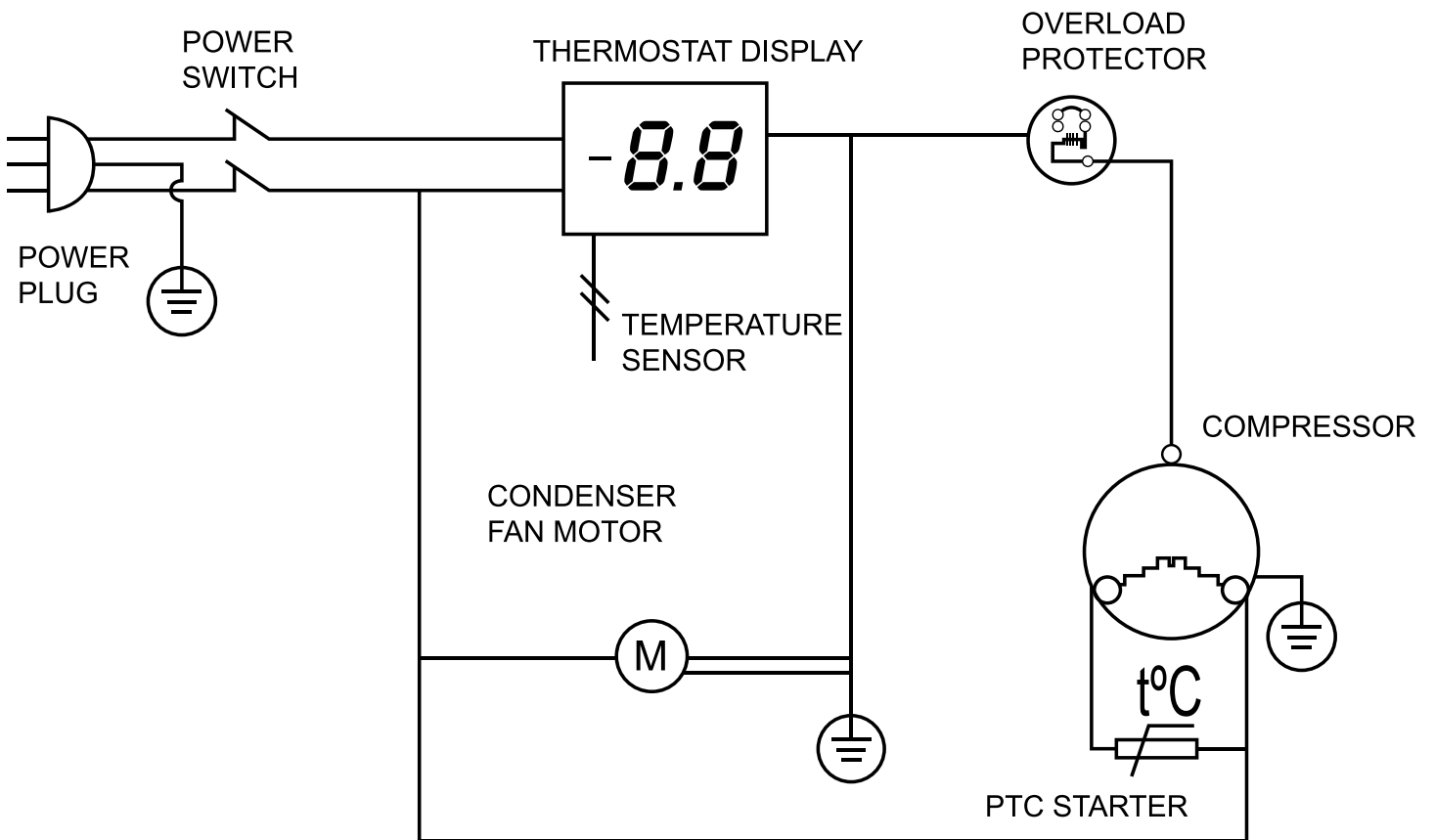



# Warranty Registration

Thank you for purchasing an Omcan product. To register your warranty for this product, complete the information below, tear off the card at the perforation and then send to the address specified below. You can also register online by visiting:

[www.omcan.com/warrantyregistration.html](http://www.omcan.com/warrantyregistration.html)



For mailing in Canada

For mailing in the US

**OMCAN INC.**  
PRODUCT WARRANTY REGISTRATION  
3115 Pepper Mill Court,  
Mississauga, Ontario  
Canada, L5L 4X5

**OMCAN**  
PRODUCT WARRANTY REGISTRATION  
4450 Witmer Industrial Estates, Unit 4,  
Niagara Falls, New York  
USA, 14305



Purchaser's Information

Name: \_\_\_\_\_

Company Name: \_\_\_\_\_

Address: \_\_\_\_\_

Telephone: \_\_\_\_\_

City: \_\_\_\_\_ Province or State: \_\_\_\_\_ Postal or Zip: \_\_\_\_\_

Email Address: \_\_\_\_\_

Country: \_\_\_\_\_

Type of Company:

- Restaurant       Bakery       Deli
- Butcher       Supermarket       Caterer

Dealer from which Purchased: \_\_\_\_\_

Institution (*specify*): \_\_\_\_\_

Dealer City: \_\_\_\_\_ Dealer Province or State: \_\_\_\_\_

Other (*specify*): \_\_\_\_\_

Invoice: \_\_\_\_\_

Model Name: \_\_\_\_\_ Model Number: \_\_\_\_\_

Serial Number: \_\_\_\_\_

Machine Description: \_\_\_\_\_

Date of Purchase (MM/DD/YYYY): \_\_\_\_\_

Date of Installation (MM/DD/YYYY): \_\_\_\_\_

Thank you for choosing Omcan



Since 1951 Omcan has grown to become a leading distributor of equipment and supplies to the North American food service industry. Our success over these many years can be attributed to our commitment to strengthen and develop new and existing relationships with our valued customers and manufacturers. Today with partners in North America, Europe, Asia and South America, we continually work to improve and grow the company. We strive to offer customers exceptional value through our qualified local sales and service representatives who provide convenient access to over 3,500 globally sourced products.

---

