

REFRIGERATOR MANUFACTURER
Turbo air
 more durable, convenient, beautiful

1250 Victoria St
 Carson, CA 90746
 Tel. 310-900-1000
 Fax. 310-900-1077
www.turboairinc.com

Project :	
Model # :	
Item # :	Qty :
Available W/H :	
Approval :	

Vertical Open Display Cases Full heights

Display Cases
 Open Display Merchandisers

Model : TOM-50(B)



TOM-50B



TOM-50



Night Curtain
 (Standard)

Security Cover
 (Optional)

≡ FEATURES / BENEFITS ≡

■ **MODERN DESIGN**

By harmonizing curvature and rigidity, our modern style product designs are user-friendly while maintaining the highest product visibility and aesthetics.

■ **AUTOMATIC CONDENSER CLEANING SYSTEM**

The accumulation of dust in the condenser causes the failure or breakdown of refrigerators. They run normally until they reach a certain level of accumulation. At some point, when they are over the limit, their performance drops quickly resulting in damage to, or disposal of the stored products in coolers. The automatic condenser cleaning system keeps the condenser clean and prevents system failure by automatically brushing daily.

■ **ENVIRONMENTALLY FRIENDLY, EFFICIENT REFRIGERATION SYSTEM**

Turbo Air's refrigerators are designed with oversized and balanced environmentally friendly R-404A (CFC Free) refrigeration. These include large evaporators and condensers for faster cooling and balanced temperature throughout the cabinet.

■ **ATTRACTIVE GLASS SIDED ELEGANT EURO DESIGN**

Glass front shield and side walls optimize the merchandiser's display effects of fresh salads, sandwiches, desserts and beverages. Its elegant contemporary euro design will enhance any store application.

■ **DESIGNED TO OPTIMIZE IMPULSE SALES**

Ideal for eye-catching displays and convenient access with fast service in high traffic area.

■ **NON-PEEL, DURABLE ANTI-RUST COATING ON THE EXTERIOR REDUCES FINGERPRINTS**

■ **STANDARD BACK-GUARD IMPROVES AIRFLOW**

■ **ENERGY SAVING NIGHT CURTAIN STANDARD OPTIONAL SECURITY COVER AVAILABLE**

■ **FOAMED WITH POLYURETHANE, HIGH-DENSITY CELL INSULATION (CFC FREE)**

■ **300 SERIES STAINLESS STEEL INTERIOR STANDARD INCLUDING BACK WALL, SHELVES AND DECK PANS**

■ **PERFORATED INTERIOR BACK WALL AND TOP FOR IMPROVED AIR FLOW**

■ **FRONT AIR INTAKE AND REAR AIR DISCHARGE**

■ **FLUORESCENT LIGHTING ON EACH SHELF**

■ **WHITE AND BLACK COLOR COME STANDARD**



Model	CU./FT.	# of Shelves	HP	AMPS	Crated Weight (lbs.)	L x D x H (inches)
TOM-50(B)	19.6	4	1	15	733	50 7/8 x 28 x 78

Model : TOM-50(B)

ELECTRICAL DATA	
Voltage	115/60/1
Plug Type	Ⓢ NEMA-5-20P
Full Load Amperes	15
Compressor HP	1
Refrigerant	R-404A
DIMENSIONAL DATA	
Net Capacity cu. ft.	19.6
Ext. Length Overall in.	50 7/8 (1292mm)
Ext. Depth Overall in.	28 (711mm)
Ext. Height Overall in.	78 1/2 (1994mm)
Int. Length Overall in.	48 3/8 (1229mm)
Int. Depth Overall in.	14 1/4 (361mm)
Int. Height Overall in.	49 7/8 (1267mm)
Gross Weight lbs.	733
Net Weight lbs.	590
# of Shelves	4
Self Size	47 3/4 x 10 3/4

Design and specifications subject to change without notice.
Actual shipping weight may differ due to extra packing materials for product protection.

- **WARRANTY : 1 Year Parts and Labor Warranty
Additional 4 Year Warranty on Compressor**
- **SIMPLE PLUG-IN INSTALLATION**
- **PATENTED SELF-CONTAINED SYSTEM, NO PLUMBING REQUIRED**
- **RECOMMENDED OPERATING CONDITIONS**
TOM models are designed to operate in an environment where temperature & humidity do not exceed 75°F and 55% respectively. Units should not be installed near HVAC vents, fans or doorways that will disrupt the air curtain and compromise the function of the cabinet. Air curtain models will run most efficiently when completely loaded with product.

■ **OPTIONAL ACCESSORIES :**

- Night time security cover

PLAN VIEW

(unit : inch)

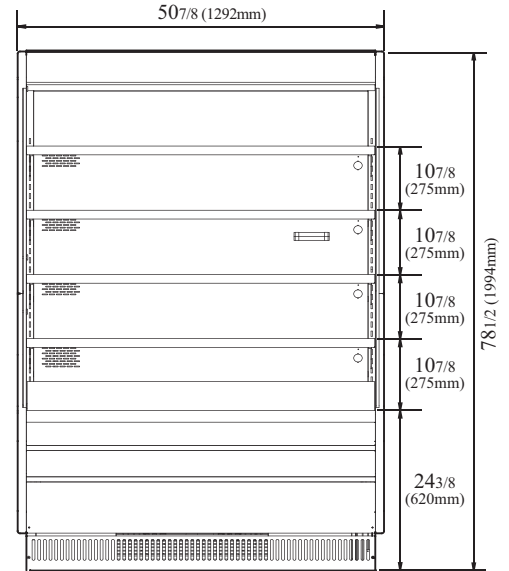

FRONT VIEW

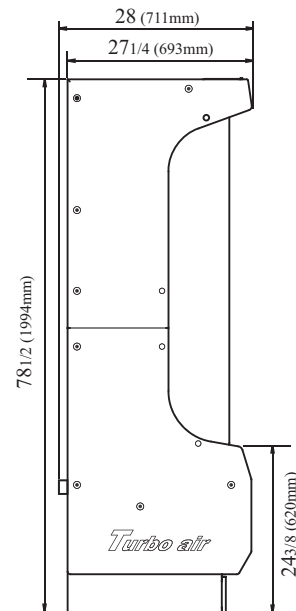

SIDE VIEW

Ver.201203



- Turbo Air : 800-627-0032
- GK : 800-500-3519
- Warranty : 800-381-7770
- AC : 888-900-1002

