

175

MIXER/GRINDER

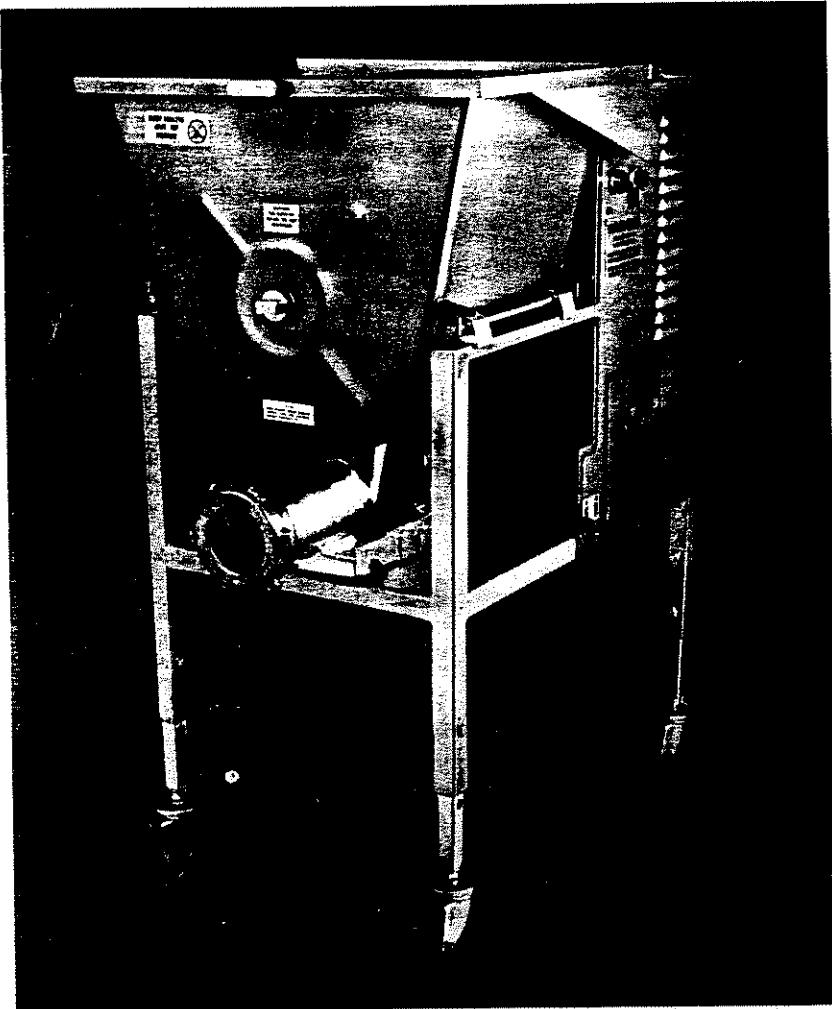

● ● ● ● ● ●
Hollymatic®

TO ALL OPERATORS

THIS MACHINE HAS BEEN FITTED WITH GUARDS DESIGNED TO PROTECT YOU FROM ACCIDENTS. RUN THE 175 ONLY WHEN ALL GUARDS AND PANELS ARE IN PLACE, AND PLEASE READ ALL THE SAFETY AND OPERATING INSTRUCTIONS IN THIS MANUAL BEFORE ATTEMPTING TO RUN MEAT.

SAVE THESE INSTRUCTIONS

Your 175 mixer-grinder will give years of top performance if operated and maintained properly. Get to know your 175 for trouble-free operation.

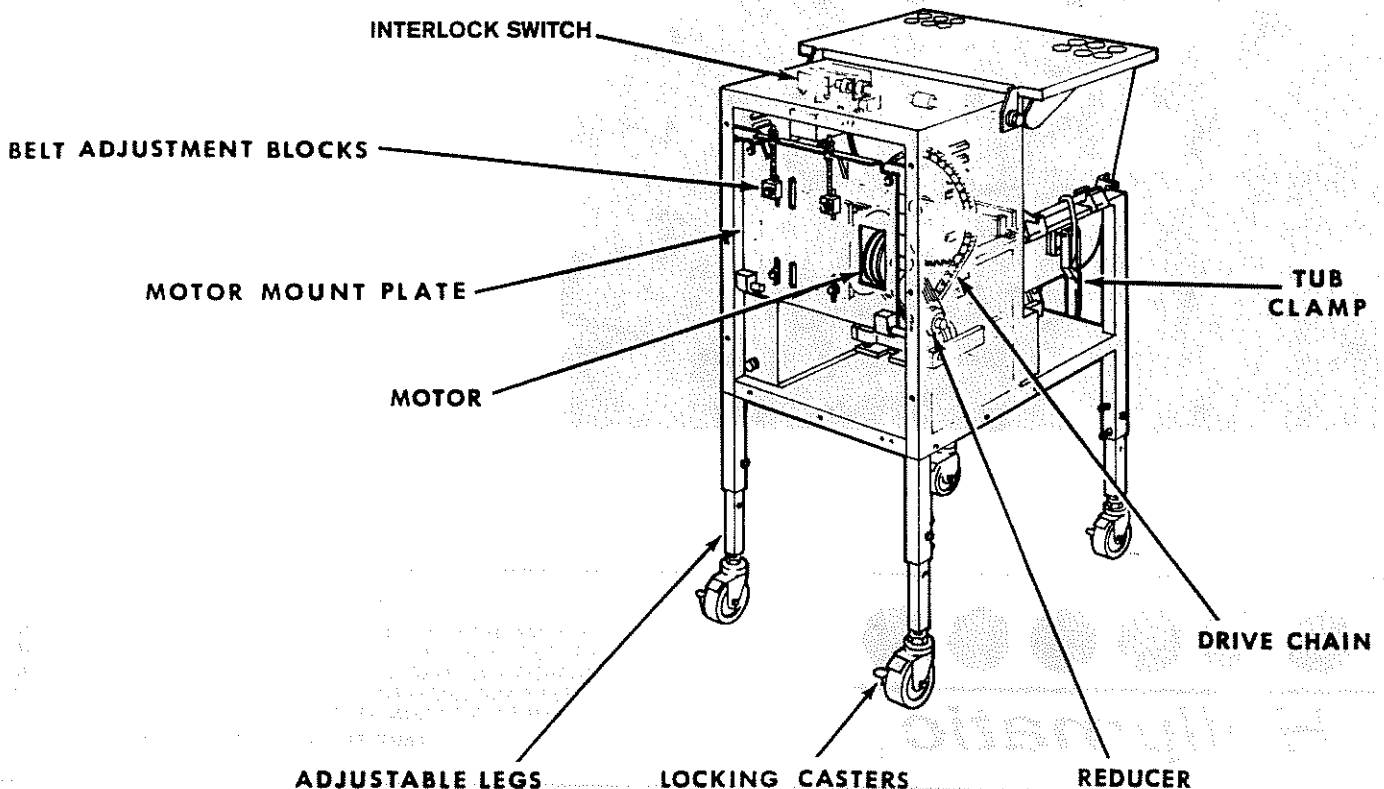
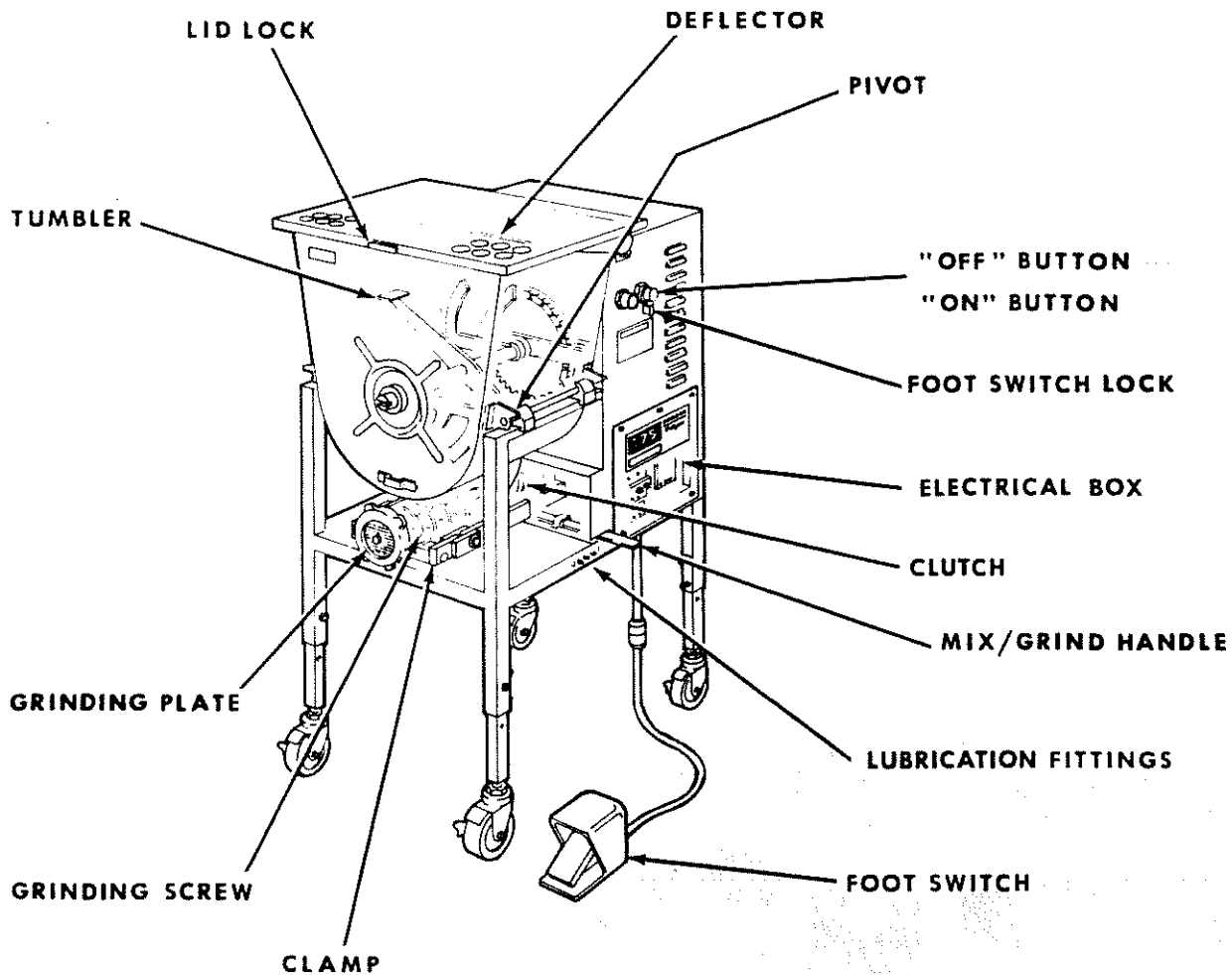

SAFEGUARDS

If each operator of the machine will follow these rules, there will be little chance of his being injured.

1. Read this manual before you operate the machine.
2. Do not operate the machine if the cord or plug is damaged.
3. Always disconnect the machine from its power source before opening the rear panel, or doing any cleaning, servicing, or adjusting of the machine.
4. Unplug the machine when it's not in use.
5. Keep hands out of tub.
6. Allow only an Authorized Hollymatic Dealer to repair your machine. He'll replace the safety labels when necessary and see that all safeguards are in good condition to prevent costly injuries.

HEIGHT ADJUSTMENT

The machine is shipped with adjustable legs fully retracted. The legs allow height adjustment from floor to center line of head of 21" min. to 31" max. Should a change in operating height be desired, follow the procedure below.

1. Remove straps, shipping bag and all equipment inside the tub. Take the machine off shipping pallet.

2. The machine weighs approx. 600 pounds. To avoid accidents make certain the machine cannot slip. Place an auto jack under center of front rail. Jack the front up to slightly above desired height and place wood blocks under the frame.

3. Remove front leg bolts and adjust legs to desired height. Replace bolts and tighten securely. Install casters on front legs.

4. Repeat procedure for back legs.

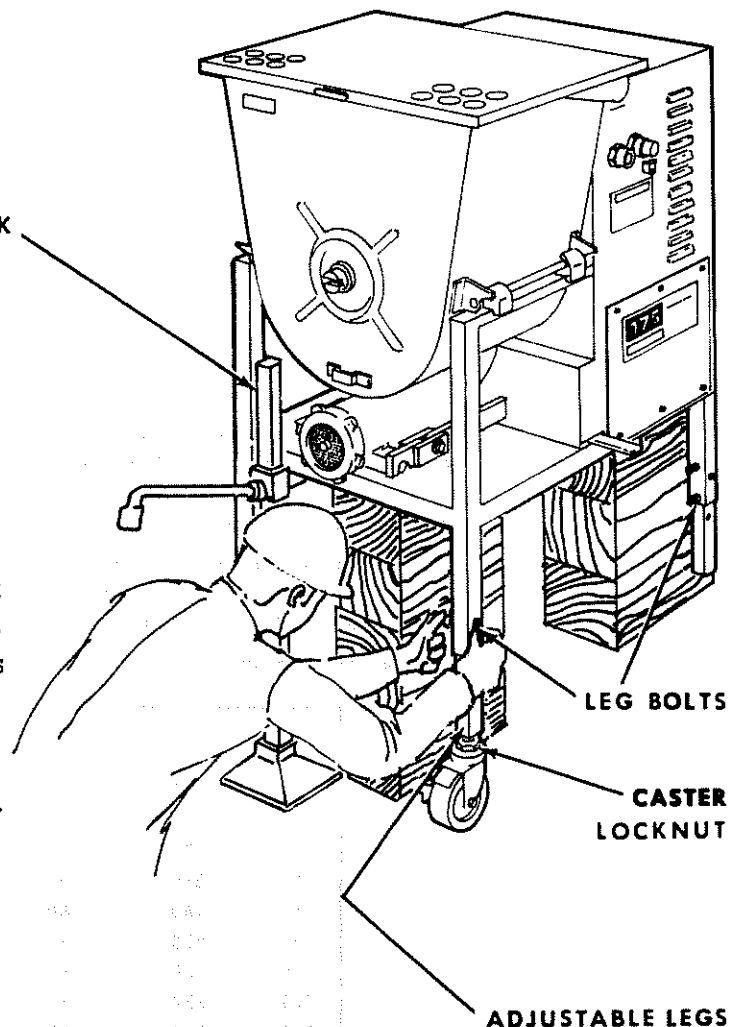

OPERATING INSTRUCTIONS

1. Always use breaker plate (3/8" or larger holes) for first grind.
2. Make sure grinding plate extends from head and is retained by locating pin.
3. Never run the 175 more than a few seconds without meat or damage to plate and knife will result.
4. Never overload the 175; capacity is 100 pounds.
5. Never run frozen meat in your 175; excessive wear, stalling or damage will result.
6. Always use knives and plates as sets for best results.
7. Clean off fat, sinew, and bone from grinder screw, plate and knife if output slows down.
8. Wash your 175 after each day's use.
9. Lubricate the 175 as shown.
10. Tighten retaining ring with ring wrench. Do not over tighten.
11. Keep and use your 175 in the meat cooler for best results.
12. Oil casters monthly; be certain that wheels turn freely.

ELECTRICAL REQUIREMENTS

1. Electrical connections to be in accordance with safety codes and National Electrical Code.
2. Rated voltage of the unit shall be identical with full supply voltage.
3. Voltage drop on the supply line shall not exceed 10% of the full supply voltage.
4. The feederline conductor size in the raceway from the branch circuit to the unit must be correct in order to assure adequate voltage under heavy starting and short overload conditions.
5. The feederline conductor size shall only be used for the supply of one unit of the relevant horsepower. For connections of more than one unit to the same feederline, a local electrician will have to be consulted to determine the proper conductor size.
6. If the fuse rating or the device setting is not sufficient to take the starting current it is permitted to increase the rating or the setting up to 400% of the full load current.
7. Listings are for induction motors only.

Hp	Volts	Hz	Ph	Amps
5	200	60	3	16.2
5	220	50	3	14.4
5	230	60	3	14.2
5	380	50	3	8.3
5	460	60	3	7.1
5	575	60	3	5.6
7.5	200	60	3	25.3
7.5	230	60	3	22
7.5	460	60	3	11

CAUTION: Before plugging machine into electrical power supply, read steps 1 through 3. Your 175 has been factory tested, but electrical phasing may not agree with your electrical supply. See specifications, page 4.

1. The 175 tub swings over to clean, or lifts off. If you desire the tub to swing to the opposite side, interchange blocks and move clamp to other side.

CARDBOARD

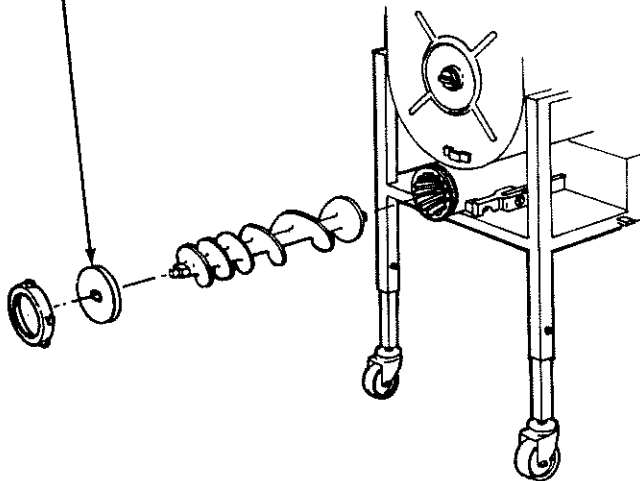

TUB MOUNT
BLOCKS

CLAMP

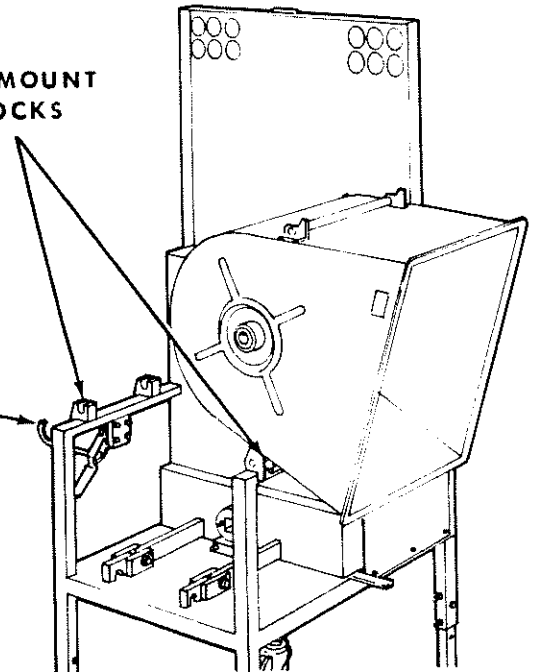

2. The 175 comes complete except for grinding plates and knife. The factory has placed cardboard in the head to retain grinding screw. Remove the cardboard.

GRINDING SCREW

3. After ascertaining correct power supply, plug the machine in. Make sure grinding screw in head engages socket in drive. Make certain top cover is closed so machine will operate. (Machine will not operate with cover open.)

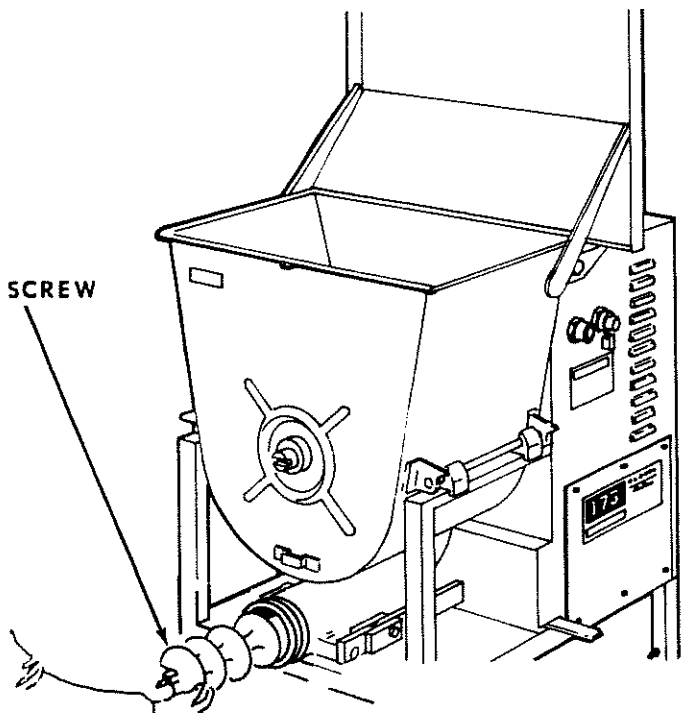

Plug the 175 into power supply.

4. Press "start" button. Check rotation of grinding screw; rotation must be counter-clockwise.

5. If the machine runs clockwise (backwards), rewire plug for correct rotation. No damage will result from running backward, but will not grind meat. (See wiring diagrams)

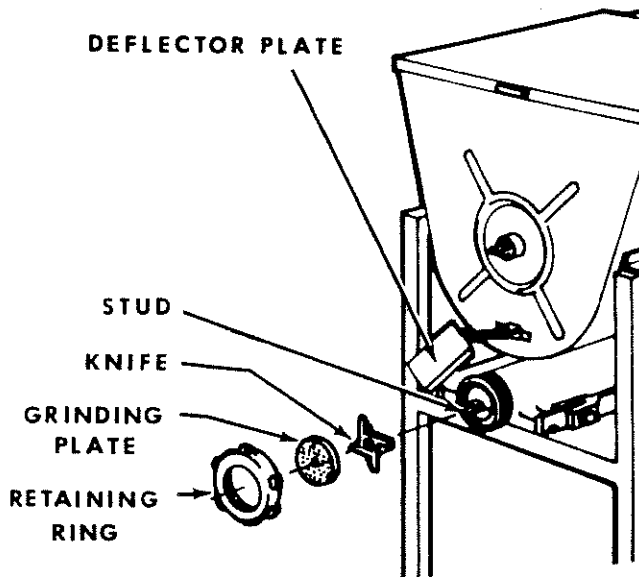
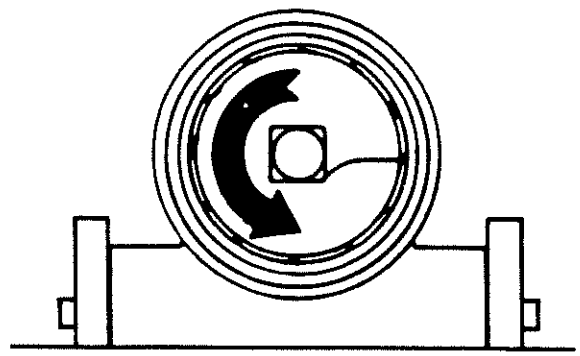

6. Slip knife (sharp edges out) onto square end of grinding screw. The breaker plate slides over end of grinding screw stud and seats on retaining pins in head. Install the retaining ring.

7. Place deflector into slot on front of tub. Use deflector for first grind to prevent splattering. The 175 is now ready to operate.

Acquaint yourself with the controls before operating the 175.

CONTROLS

The top cover swivel operates an inter-lock switch. The 175 will not operate with this cover open. Make certain cover is fully closed and locked.

Should the cover be opened during operation, machine will not operate again until "on" button is pressed.

Hand operation: Press green (on) button to operate the machine. Press red (off) button to stop. If motor should ever stall due to overload, press stop button and wait about a minute for motor to reset automatically.

To use footswitch, push lock over "off" button. Machine now will run with pressure on footswitch. Releasing pressure stops the machine.

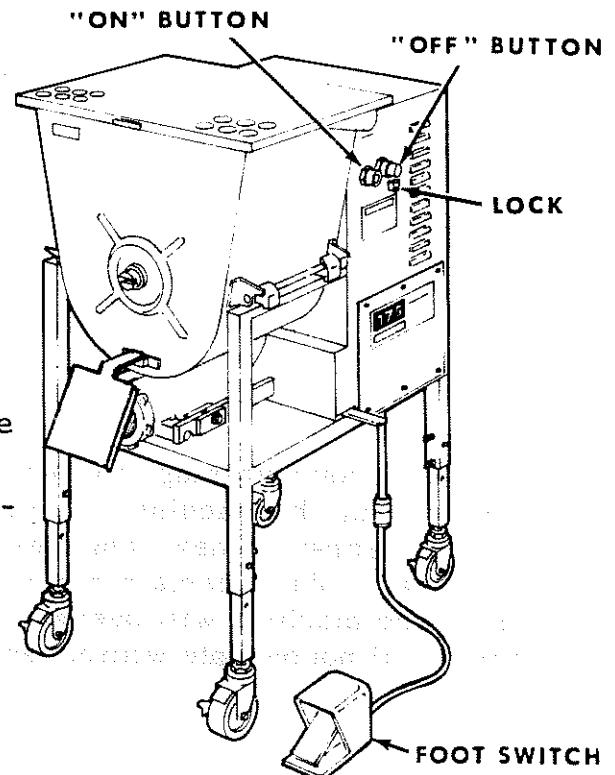

The mix/grind lever is below the on-off buttons. The mixing tumblers run whenever the 175 is operated. The grind is selective.

1. Mix only: Pull lever forward until it locks in place. The grinding screw is disengaged.

2. Mix and grind: Push lever towards rear of machine to engage grinding screw. The 175 will now grind itself empty.

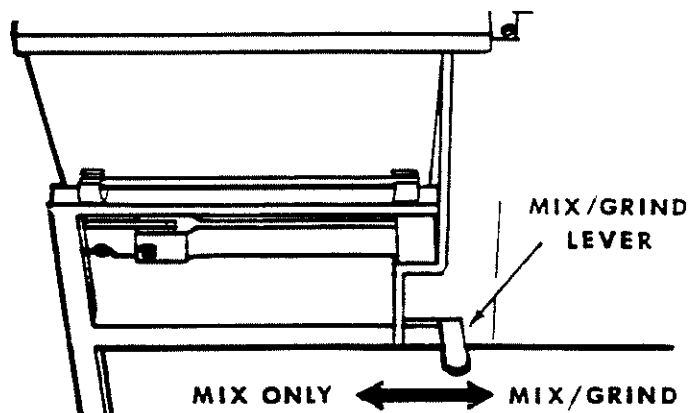

OPERATION

Never grind meat colder than 30 degrees F. For first grind, always use a grind plate with $\frac{3}{8}$ " diameter holes. For final grind, always use a grind plate with $\frac{1}{8}$ " diameter holes.

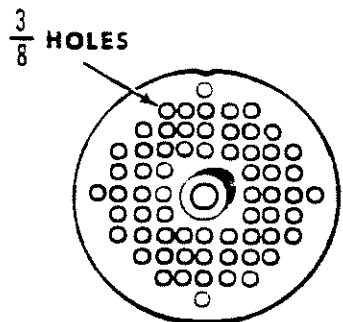

FIRST GRIND PLATE

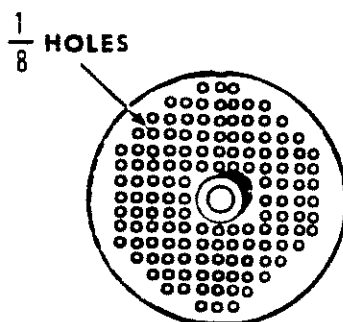

FINAL GRIND PLATE

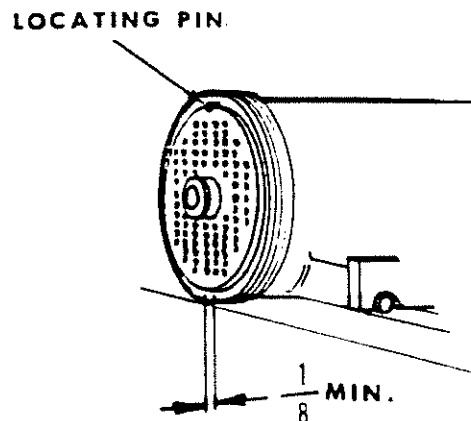

Make certain grinding plate extends from head when in place. Locating pins must engage slots in plate to prevent rotation of plate.

1. With knife, breaker plate, and retaining ring in place, slide lever to "mix/grind" position. Load the machine with 100 lbs. of meat.

2. Close lid and slide handle to lock. Turn on machine: it will automatically grind the 100 lbs. After the machine has ground itself empty, turn it off.

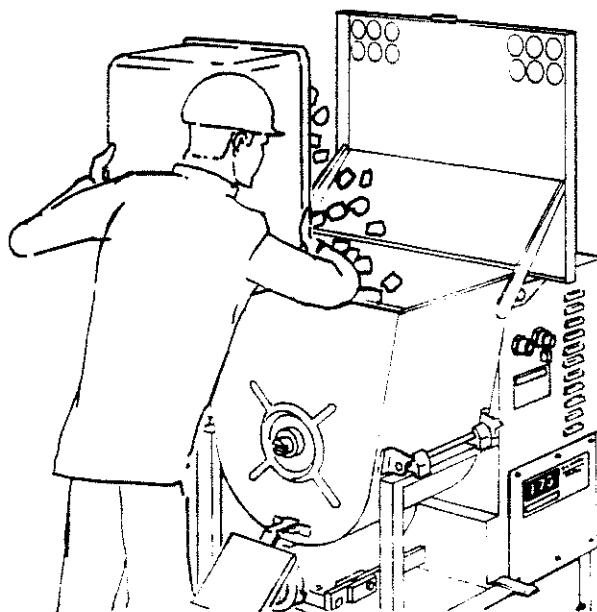

SECOND GRIND

1. Using wrench provided, remove retaining ring. Replace breaker plate with final grind plate. Move selector handle to "mix".

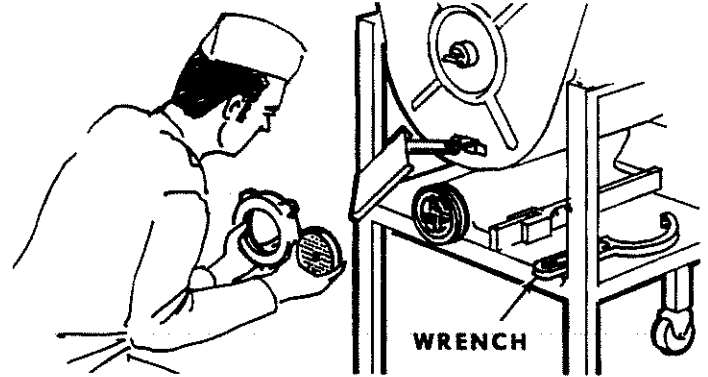

2. Blend an average mix of fat and lean for approximately 30 seconds. A difficult mixture, including additions of soy, spices or water will take approximately 1 minute. With an extremely difficult mix, blend fat and lean before adding soy, spices, etc.

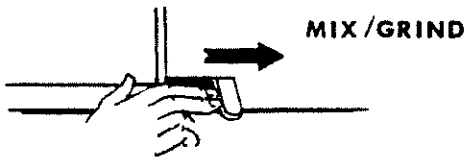

3. After mixing, push lever to "mix/grind" position. The 175 will continue to blend while grinding itself empty.

4. If the 175 is used for final grind only, it may experience fat build-up on the grinder screw and plate. To clean out the fat, simply drop a few chunks of lean meat into the tub and grind. The lean meat and grinding action will clean out fat build-up.

DISASSEMBLY

To comply with sanitation regulations, the 175 should be cleaned after each working day. Disassembly is simple; no special tools are required. Unplug the machine before disassembling.

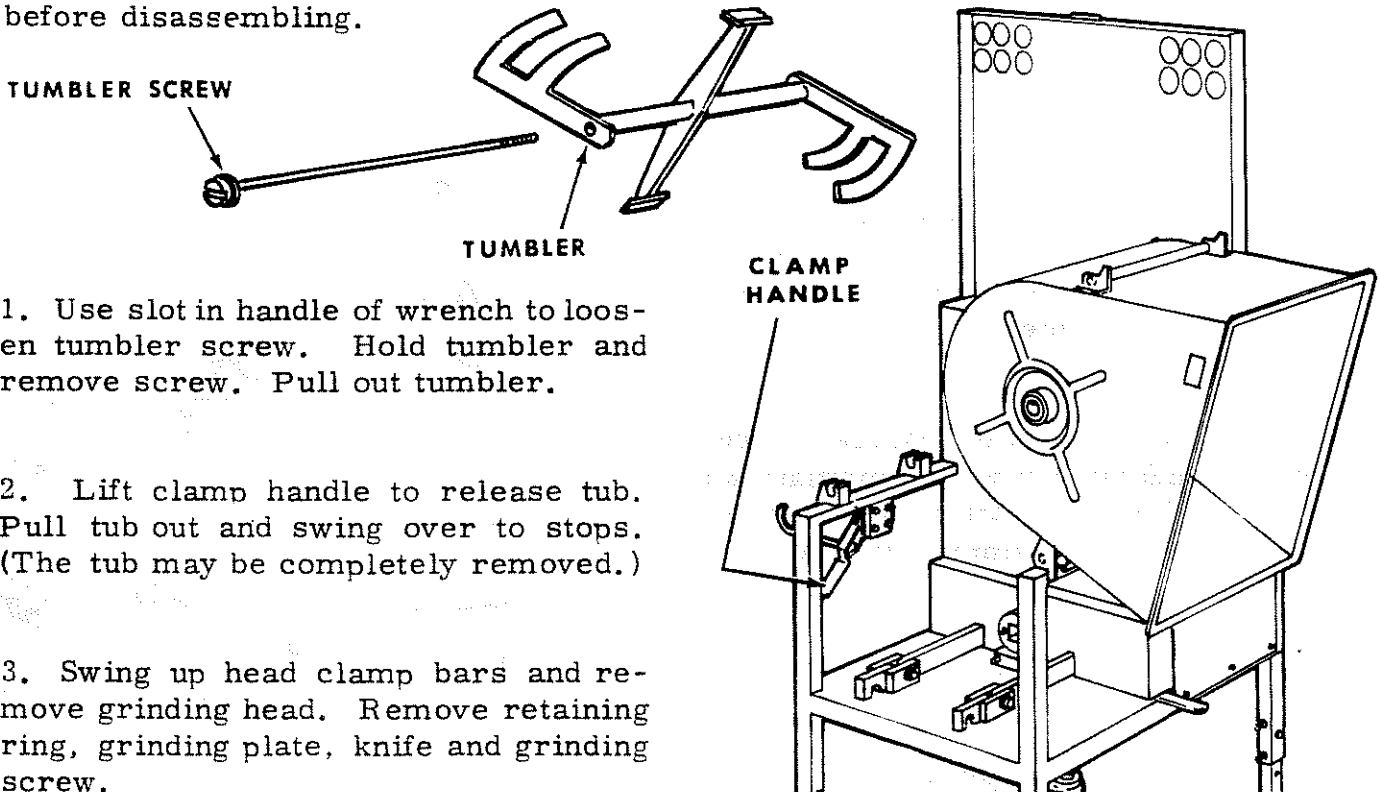

1. Use slot in handle of wrench to loosen tumbler screw. Hold tumbler and remove screw. Pull out tumbler.

2. Lift clamp handle to release tub. Pull tub out and swing over to stops. (The tub may be completely removed.)

3. Swing up head clamp bars and remove grinding head. Remove retaining ring, grinding plate, knife and grinding screw.

CLEANING

After disassembly, wash the tub off with hot water. Wash retaining ring, grinding plates, knives, grinding screw, head and tumbler thoroughly.

Wash 175 cabinet with hot water to remove any meat particle residue.

Clean the grinding head thoroughly, including the threads. The retaining ring cannot seat correctly if the threads are clogged with meat residue.

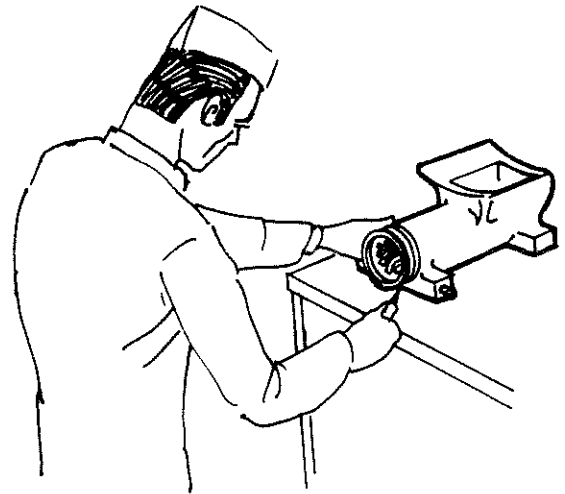

A clean 175 operates better and longer. After cleaning, wipe everything dry. Follow lubrication schedule below.

LUBRICATION

It is most important to keep your 175 properly lubricated. A clean, well-cared for machine will last many times longer than a dirty one.

Immediately after cleaning, oil parts below with Holly Oil to prevent any overnight oxidation.

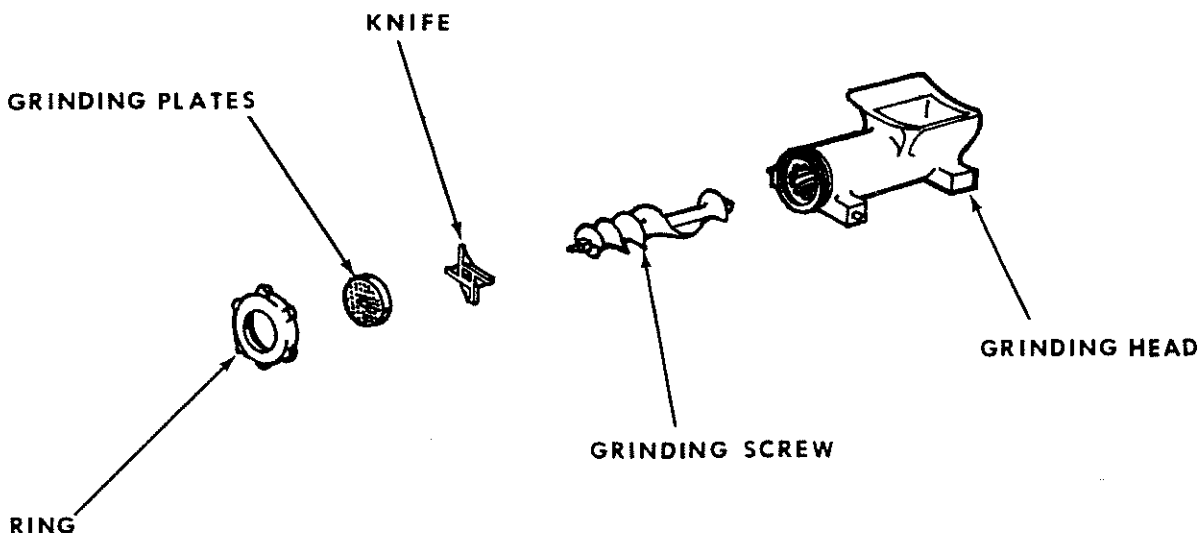

Your 175 has only a few places where lubrication is required, but it is important to follow the lubrication schedule as shown. A well-lubricated machine will operate better and longer.

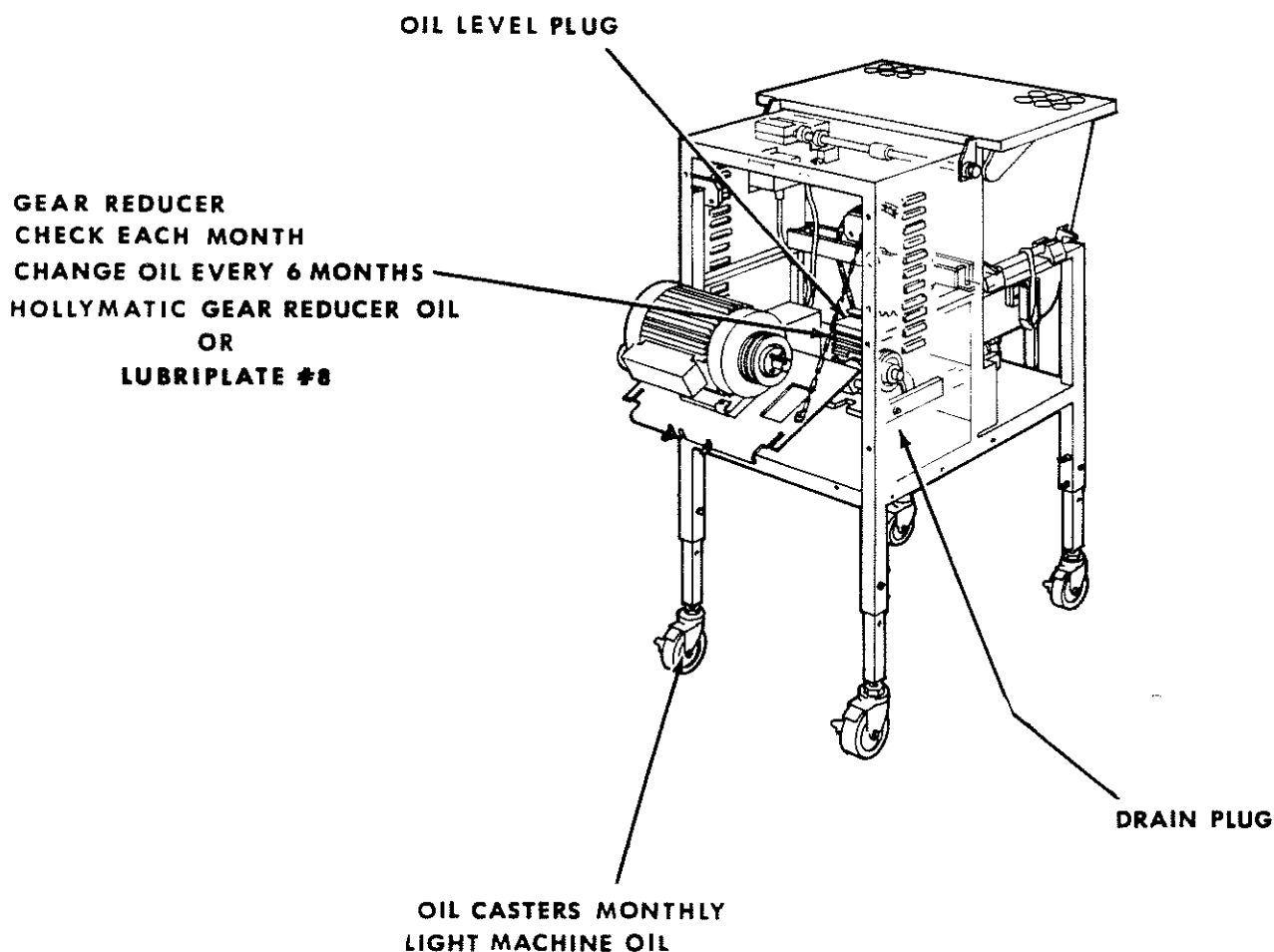
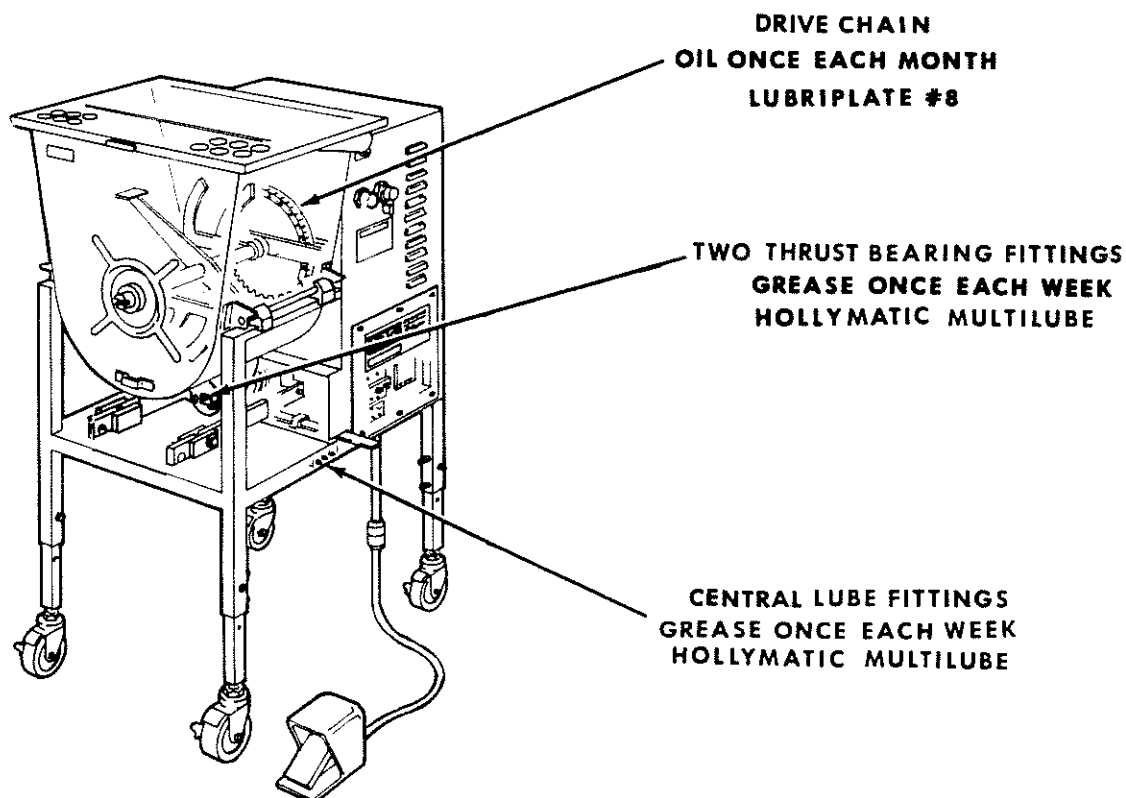

REASSEMBLY

1. Place grinding head on shelf. Swing clamps down over pins in front of head.

2. Swing tub down and push back. Use clamp to retain in place.

3. Place tumbler in tub. Keyed end of tumbler fits into drive socket. Retain

with long stud through center of tumbler; tighten stud with notched end of ring wrench.

4. Place grinding screw in head so square engages socket in drive. Install knife, plate and retaining ring (see page 3). Plug into power source; 175 is ready to run.

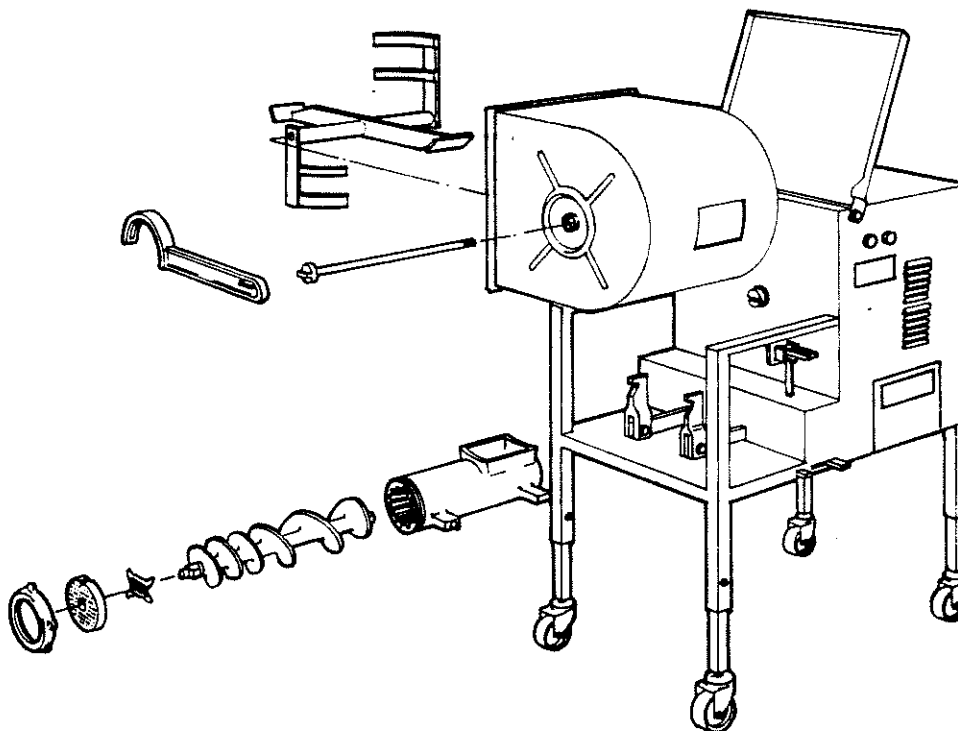

GEMINI

Your 175 may be used for first or final grind as a part of a HOLLYMATIC Gemini. If the 175 is to be used as first grinder, install adapter between plate and ring. Roll the 175 to insert adapter into inlet in final grind tub. Lock with thumbscrews.

If used as final grind, operate as normal.

If a Gemini 175 is used alone, put cap on tube inlet.

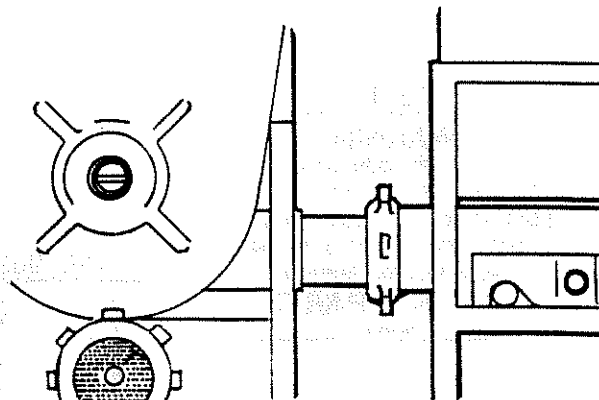

900 0103

WARNINGDO NOT OPERATE
WITHOUT GUARDSREAD OPERATOR'S MANUAL
BEFORE RUNNING MACHINEUNPLUG MACHINE BEFORE
CLEANING OR ADJUSTINGKEEP HANDS AWAY FROM
MOVING PARTS

900 1038

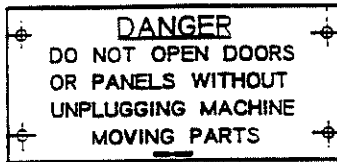

(LOCATED ON MOTOR MOUNT)

900 0610

150 9023
CAUTION
TUB CAPACITY
100 LBS. DO NOT
OVERLOAD

900 1037

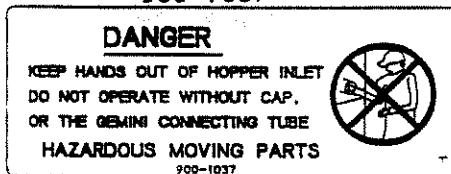

(GEMINI OPTION)

900 1045

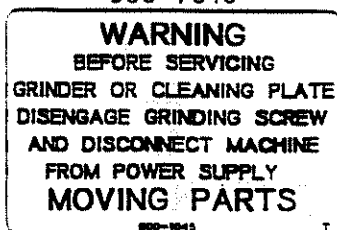

150 9024

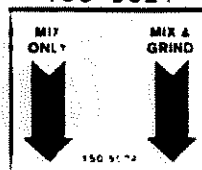

900 1002

TO OPERATE FOOT SWITCH
PUT STOP BUTTON IN LOCK
POSITION

900 1049

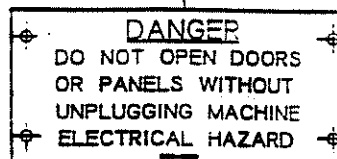
PRIMARY FUSE
900-1035FUSE
1 AMP 200V
900-1032FUSE
1 AMP 230V
900-1033FUSE
.5 AMP 480V
900-1034

900 1039

HOLLYMATIC 175

WIRING DIAGRAM

(150-8210)

FOR UL APPROVED MACHINES

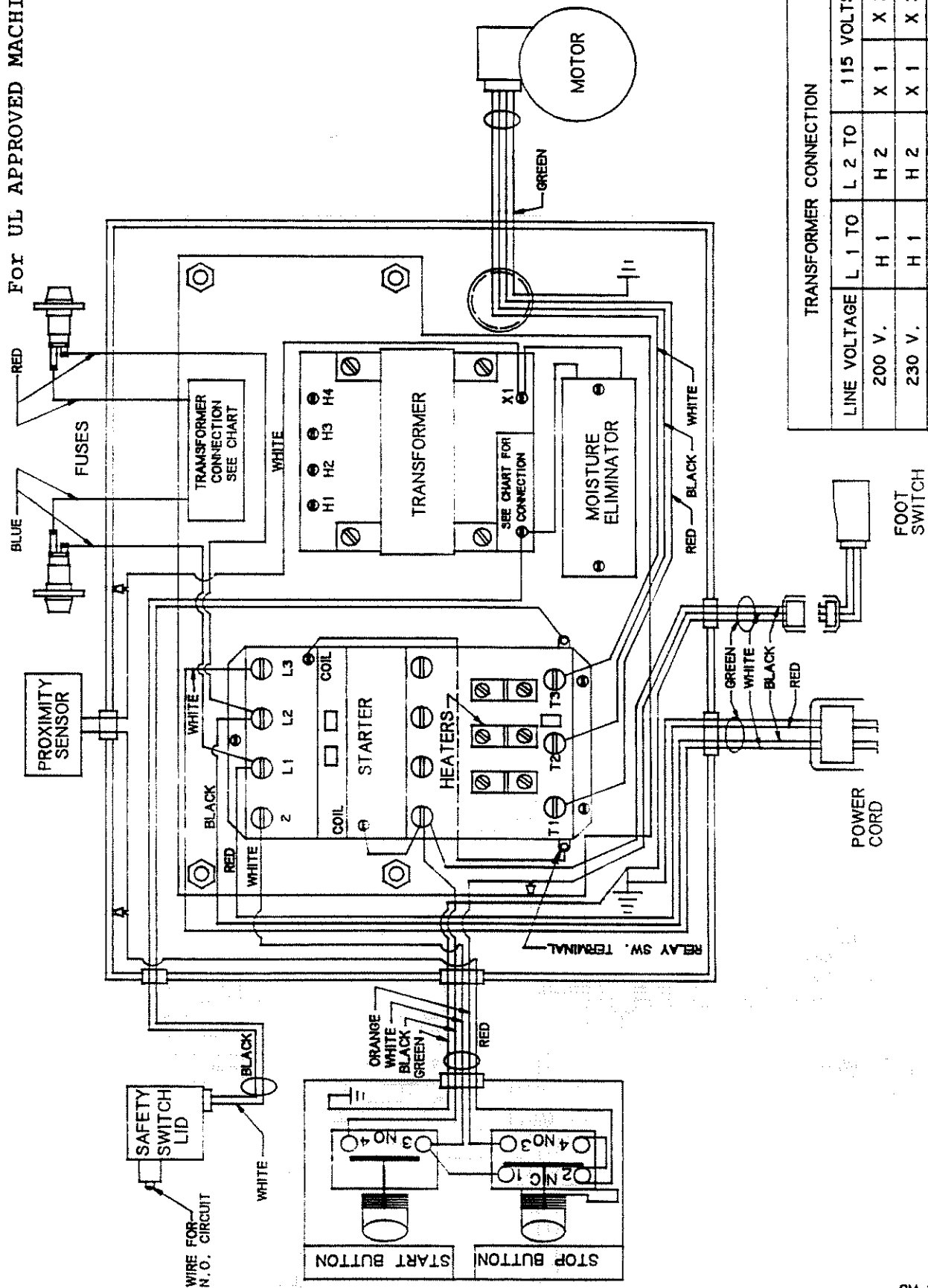

GM-8210

200V 3PH 60HZ 5HP
CSA/OLD STYLE

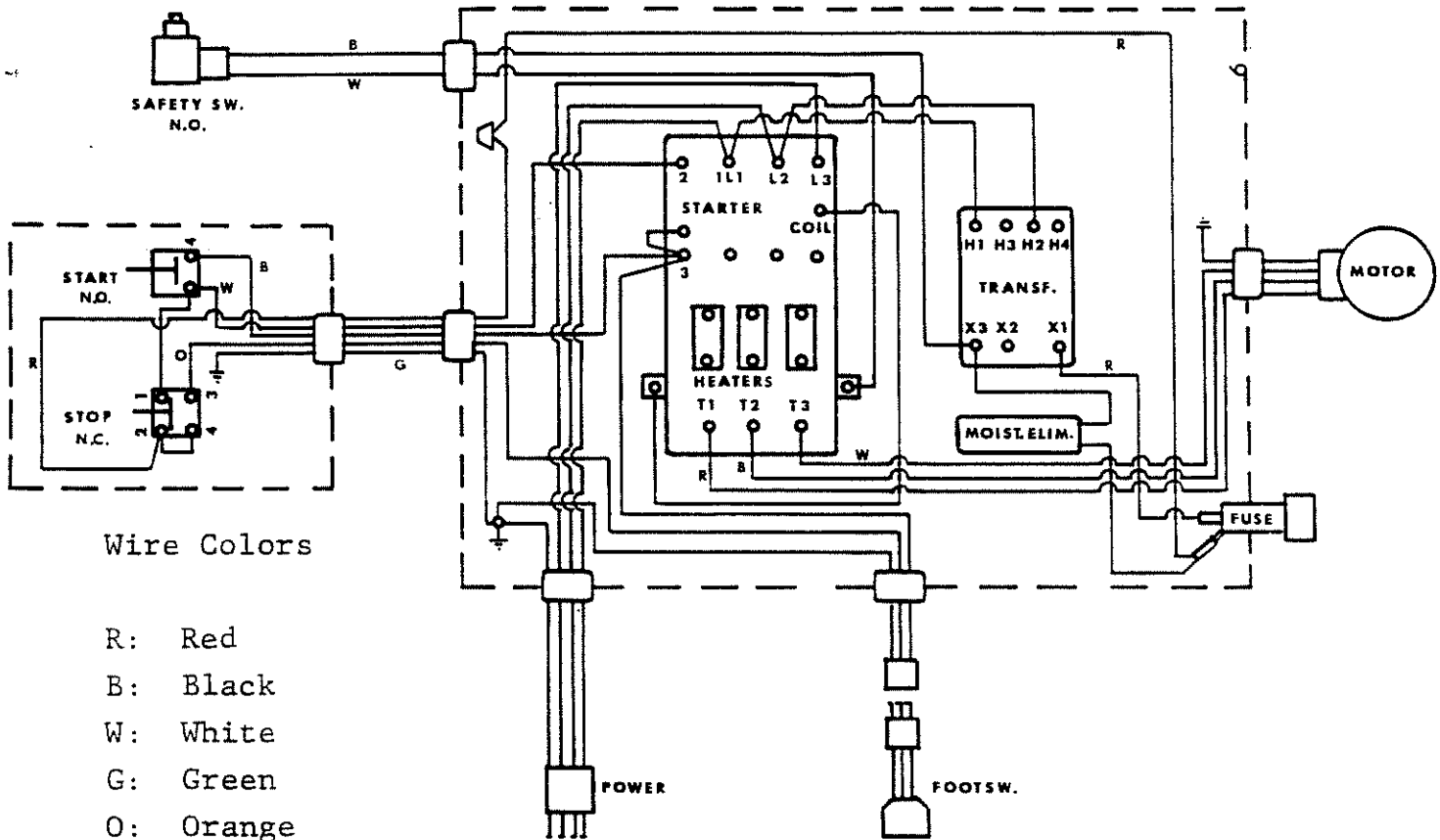

230V 3PH 60HZ 5HP
CSA/OLD STYLE

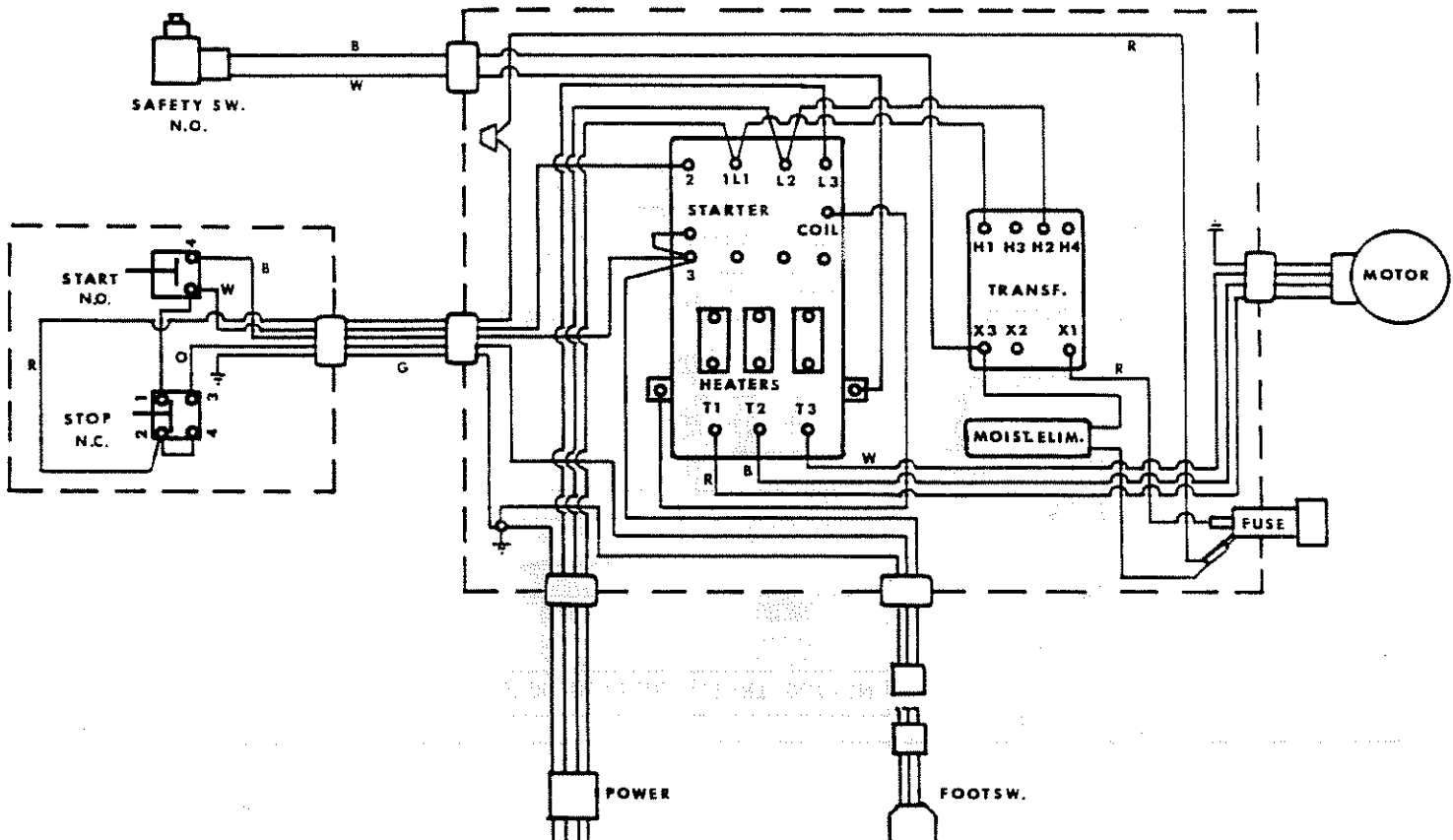

CSA/OLD STYLE
380V 3PH 50HZ 5HP

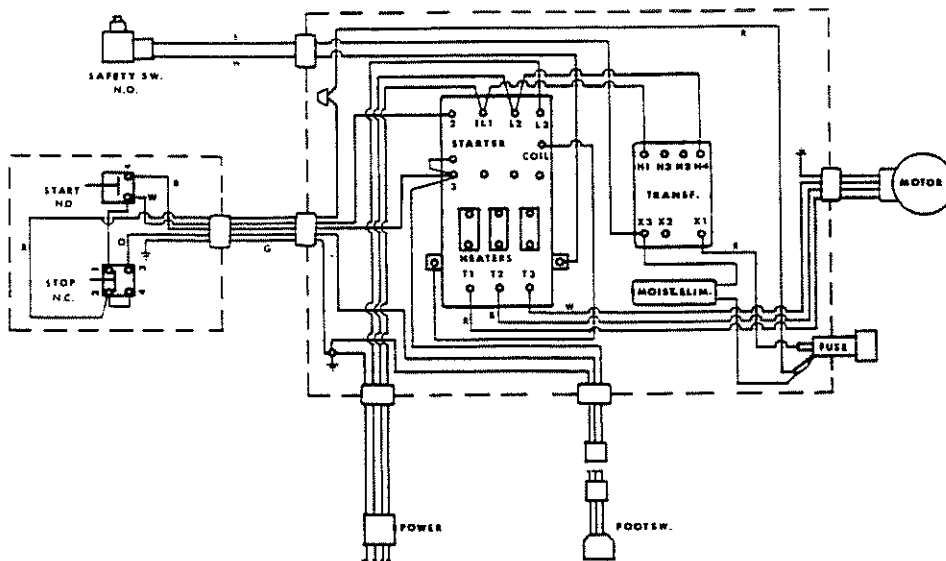

CSA/OLD STYLE
460V 3PH 60HZ 5HP

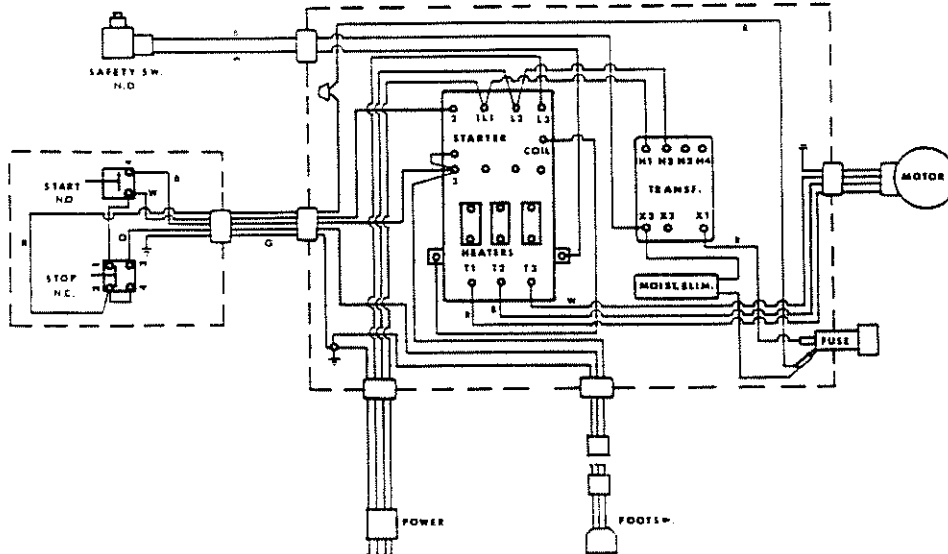

CSA/OLD STYLE
575V 3PH 60HZ 5HP

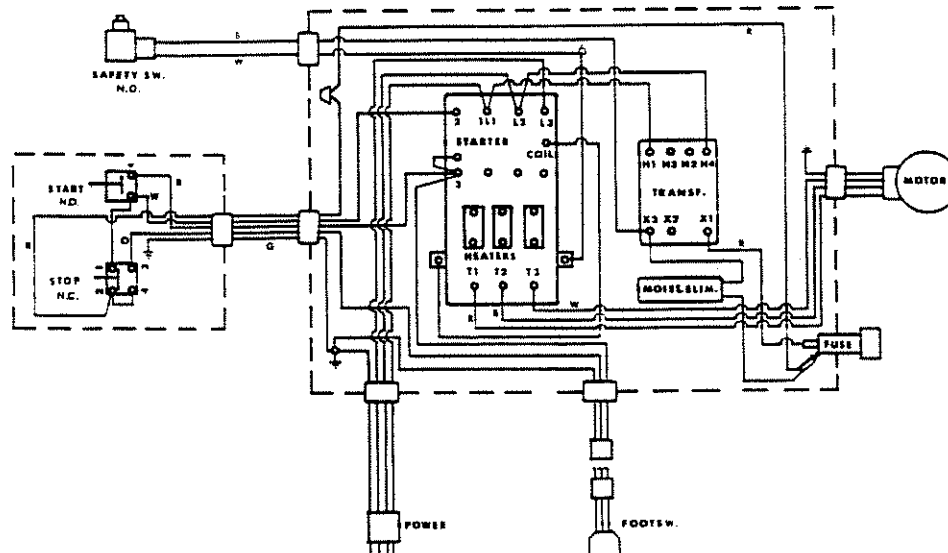

CSA/OLD STYLE
200V 3PH 60HZ 7.5 HP

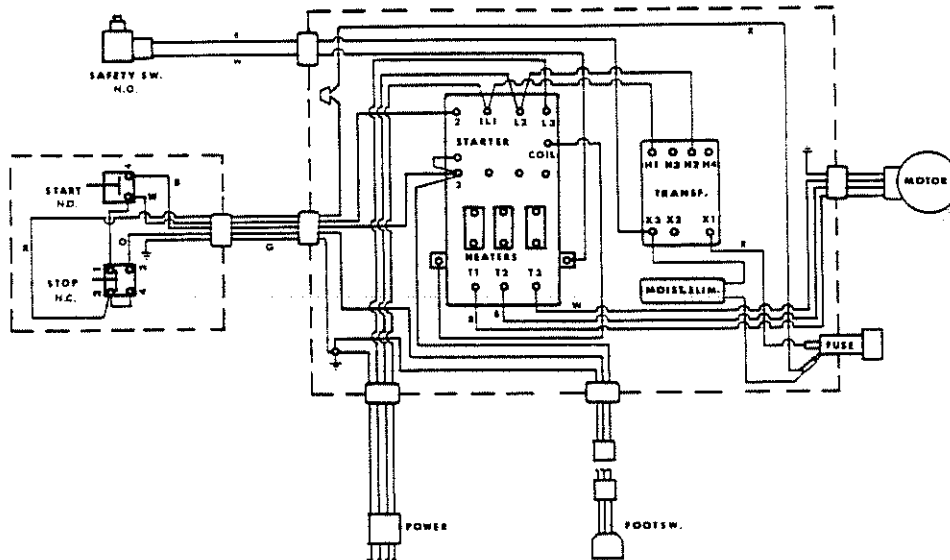

CSA/OLD STYLE
230V 3PH 60HZ 7.5 HP

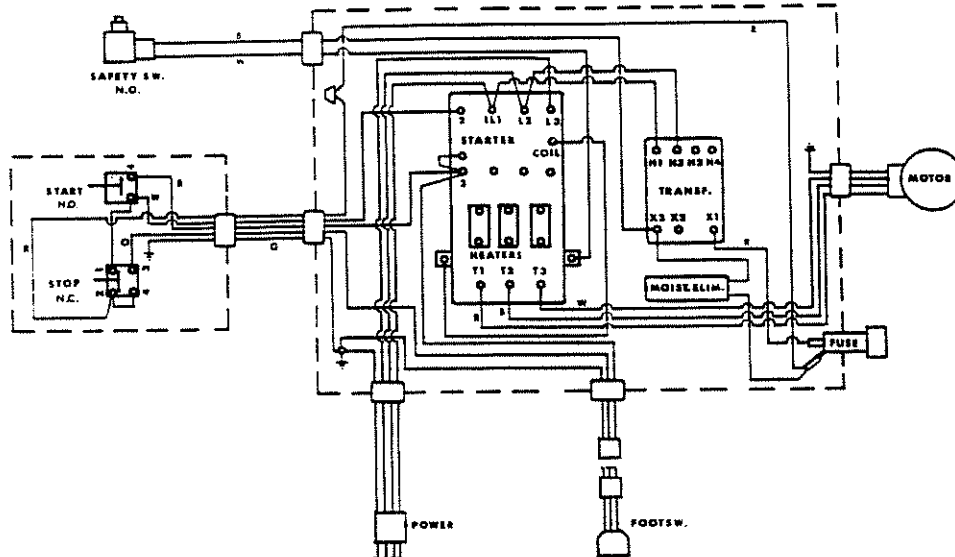

CSA/OLD STYLE
460V 3PH 60HZ 7.5 HP

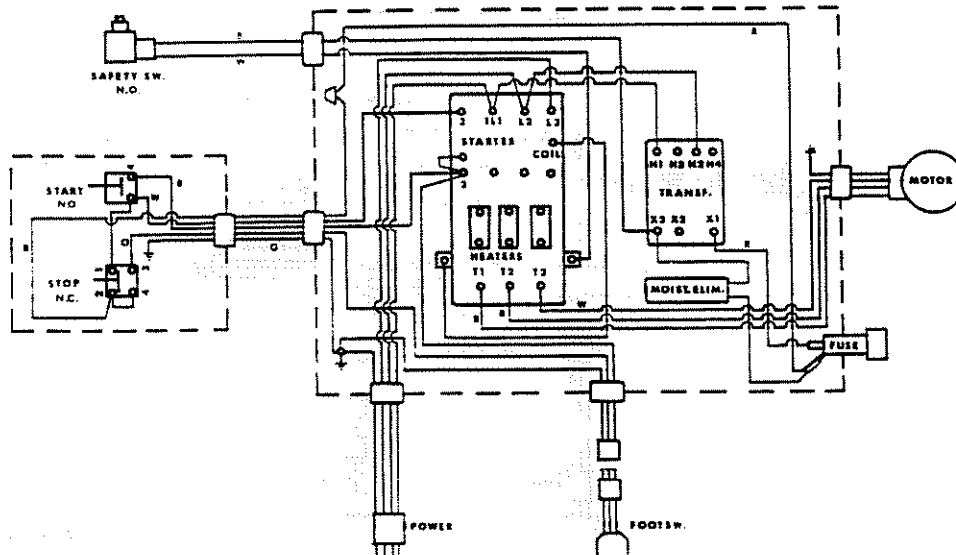

ELECTRICAL COMPONENTS

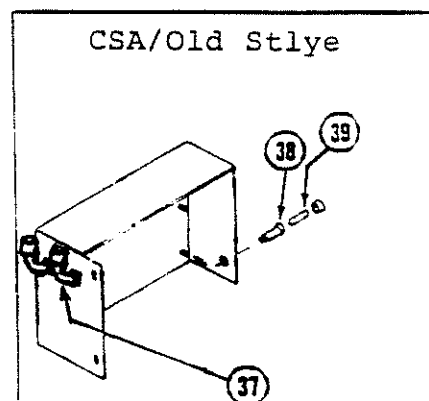
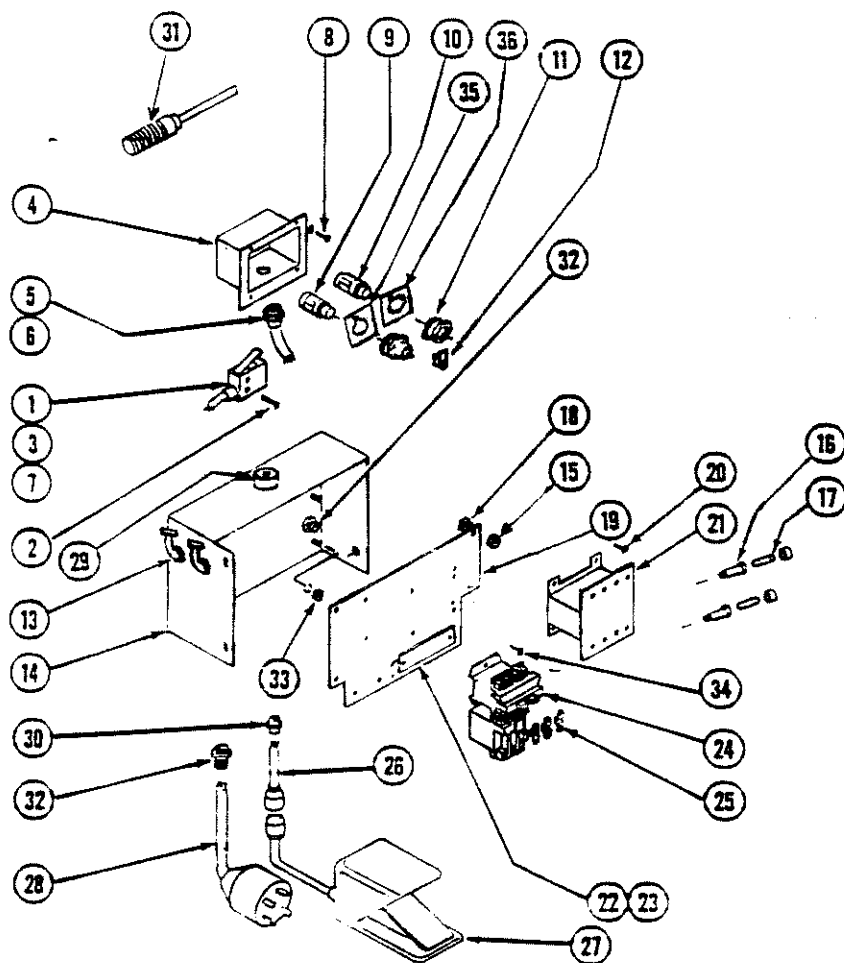

ITEM	QTY	PART NO.	ITEM	QTY	PART NO.
1 Safety Switch, Lid	1	150 9299	25 Heater:		
2 Bolt Assortment	3	150 9345	5 HP, 200V/60Hz	3	100 0777-47
3 Connector, 90deg.	1	2701	5 HP, 230V/60Hz	3	100 0777-46
4 Enclosure, Push Button	1	150 3219	5 HP, 380V/50Hz	3	100 0777-40
5 Cord Clamp	1	2274	5 HP, 460V/60Hz	3	100 0777-38
6 Cord Assembly:	1		5 HP, 575V/60Hz	3	100 0777-36
Right Hand	1	150 3268	7.5 HP, 200V/60Hz	3	100 0777-52
Left Hand	1	150 9327	7.5 HP, 230V/60Hz	3	100 0777-50
7 Cord Ass'y, Switch	1	150 3256	7.5 HP, 460V/60Hz	3	100 0777-43
8 Bolt Assortment	4	150 3252	26 Cord Ass'y, Foot Switch	1	150 0079
9 Push Button, Start	1	100 1027	27 Footswitch:		
10 Push Button, Stop	1	100 1028	3 Phase (UL)	1	100 0974
11 Spacer Seal	9	100 0932	3 Phase (CSA)	1	150 8034
12 Lock, Push Button	1	100 1029	1 Phase	1	150 8035
13 Cord Connector, 90deg.	2	2701	28 Cord Assembly:		
14 Electrical Box Weldment	1	150 0077	5 HP, 200/230V/3PH/60Hz	1	150 3280
15 Nut	6	734005140	7.5 HP, 230/3/60	1	150 3286
16 Fuseholder, Large	2	190 0174	5 HP, 380/3/50	1	150 3287
17 Slo-Blo Fuse:			5/7.5 HP, 460/3/60	1	150 3287
1/2 Amp	2	190 0174	5 HP, 575/3/60	1	150 3288
1 Amp	2	190 0176	7.5 HP, 200/3/60	1	150 3289
18 Jam Nut	4	734008240	29 Cord Connector, Prox. Sensor	1	879 1959
19 Electrical Panel	1	150 0075	30 Cord Clamp	1	100 0954
20 10-24x3/8 Truss H.M.S.	4	713031540	31 Proximity Sensor	1	244 0376
21 Transformer:			32 Cord Connector	2	100 0845
200/277/380V (UL)	1	181 0782	33 1/4" Ext Lock Washer	4	754000740
230/460/575V (UL)	1	181 0781	34 8-32 x 3/8 Pan H.M.S.	3	712031640
5 HP 380V (50HZ)	1	181 0333	35 Legend, Start Plate	1	181 0802
200V (CSA)	1	181 0333	36 Legend, Stop Plate	1	181 0803
230/575V (CSA)	1	181 0332	37 Cord Connector, 90deg.	2	860 0518
22 Moisture Elim. Ass'y	1	150 9346	38 Fuseholder	1	500 1251
23 Screw	3	712031640	39 Fuse	1	181 0392
24 Starter	1	150 3261			

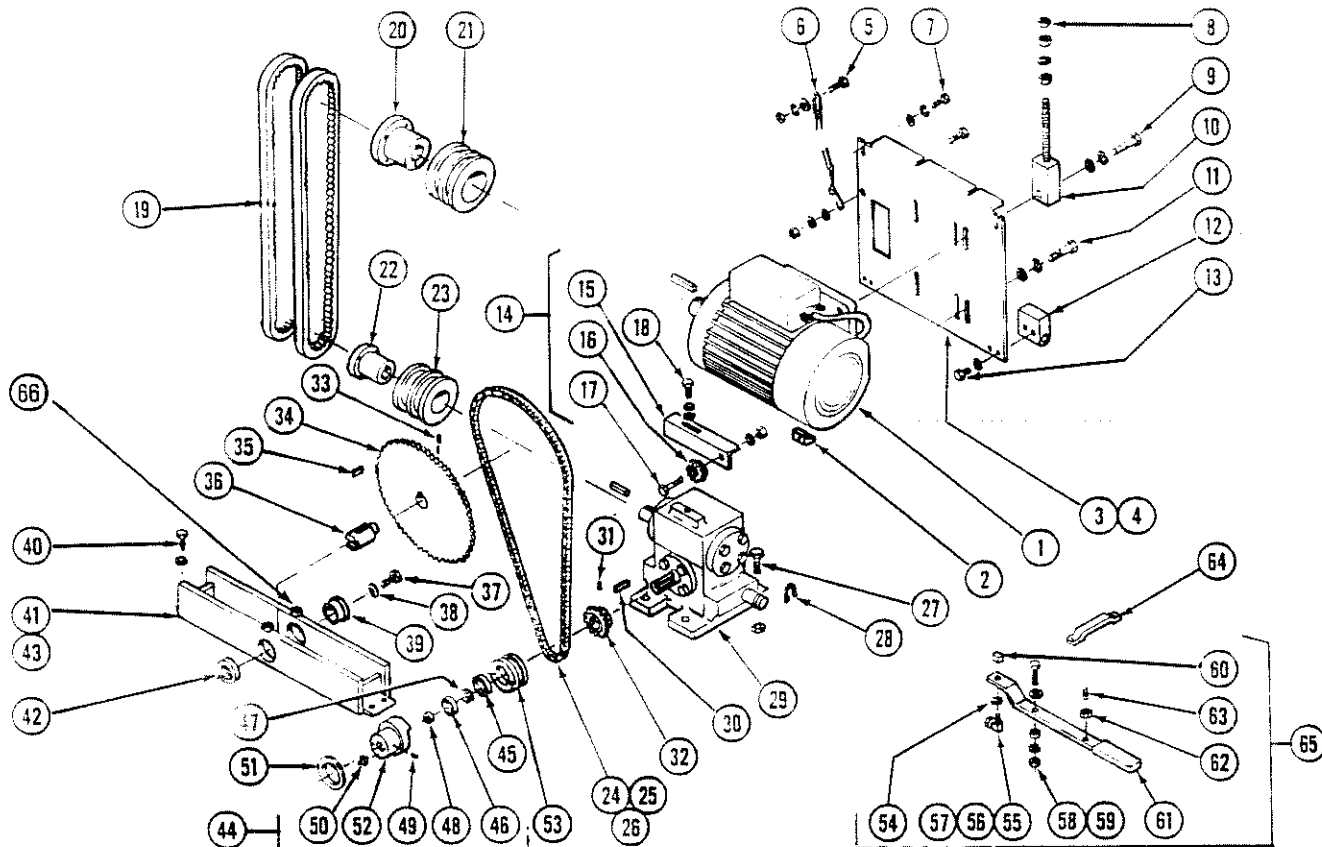

ITEM	QUANTITY	PART NO.	ITEM	QUANTITY	PART NO.
1 Motor, 5 Hp. 200V/3Ph/60Hz	1	150 8106	31 Screw, Lock	2	714 0344 99
Motor, 5 Hp. 230V/460V/3Ph/60Hz	1	150 8108	32 Sprocket, Drive	1	150 2056
Motor, 5 Hp. 380V/3Ph/50Hz	1	150 8110	33 Screw, Lock	2	715 0337 99
Motor, 5 Hp. 575V/3Ph/60Hz	1	150 8111	34 Sprocket, Driven	1	150 2081
Motor, 7.5 Hp. 200V/3Ph/60Hz	1	150 8136	35 Key	1	150 2082
Motor, 7.5 Hp. 230/460V/3Ph/60Hz	1	150 8135	36 Shaft, Tumbler Drive	1	150 2508
2 Nut, Motor Mount	4	150 0070	37 Bolt	1	150 2510
3 Plate, Motor Mount	1	150 0065	38 Cap. Ret.	1	150 2509
4 Decal, Caution	1	900 0642	39 Bearing	1	150 0135
5 Bolt Assortment	2	150 9272	40 Bolt Assortment	1	150 3251
6 Chain, Safety	1	150 9271	41 Connector, Cr.	1	150 1972
7 Bolt Assortment	2	150 3250	42 Bearing	1	150 0134
8 Nut Assortment	2	150 3274	43 Housing, Tumbler	1	150 0131
9 Bolt Assortment	2	150 0073	44 Clutch Assembly	1	150 2043
10 Hanger, Motor	2	150 0069	45 Seal	1	150 2050
11 Bolt Assortment	2	150 0072	46 Cup, Bearing	1	150 2049
12 Block, Pivot	2	150 0071	47 Bearing	1	150 2048
13 Bolt Assortment	4	150 3273	48 Bushing	1	150 2047
14 Idler Bracket Assembly	1	150 2071	49 Screw, Set	1	723 0244 99
15 Bracket	1	150 2075	50 Grease Fitting	2	150 9170
16 Sprocket	1	150 2079	51 Seal	1	150 0337
17 Bolt Assortment	1	150 2074	52 Clutch, Driven	1	150 2044
18 Bolt Assortment	1	150 2076	53 Clutch, Drive	1	150 2042
19 Belt, Drive	2	150 3248	54 Washer	1	150 2527
20 * Bushing - 5 H.P.	1	150 3243	55 Block	1	150 2522
21 * Pulley, Motor - 5 H.P.	1	150 3242	56 Elbow	1	150 2526
22 Bushing 5 H.P. & 7½	1	150 3247	57 Connector	1	150 9172
23 * Pulley, Reducer 5 H.P.	1	150 3244	58 Bolt Assortment	1	150 2519
24 Chain Assembly	1	150 2062	59 Bushing	1	150 2520
25 Link, Connecting	1	150 2066	60 Block	1	150 2522
26 Link, Offset	1	150 2068	61 Handle	1	150 2517
27 Bolt Assortment	4	150 2505	62 Nut	1	746 0051 23
28 Ring, Retaining	2	773 0020 93	63 Detent	1	350 0201
29 Reducer Assembly	1	150 2502	64 Strap, Clutch	1	150 2524
30 Key	1	150 2057	65 Handle Assembly, Clutch	1	150 2516
* Bushing 7½ HP-use 150-3326			66 Grease Coupling	2	150 1972
Pulley, Motor 7½ HP-use 150-3327					
Pulley, Reducer 7½ HP-use 150-3328					

MAIN FRAME

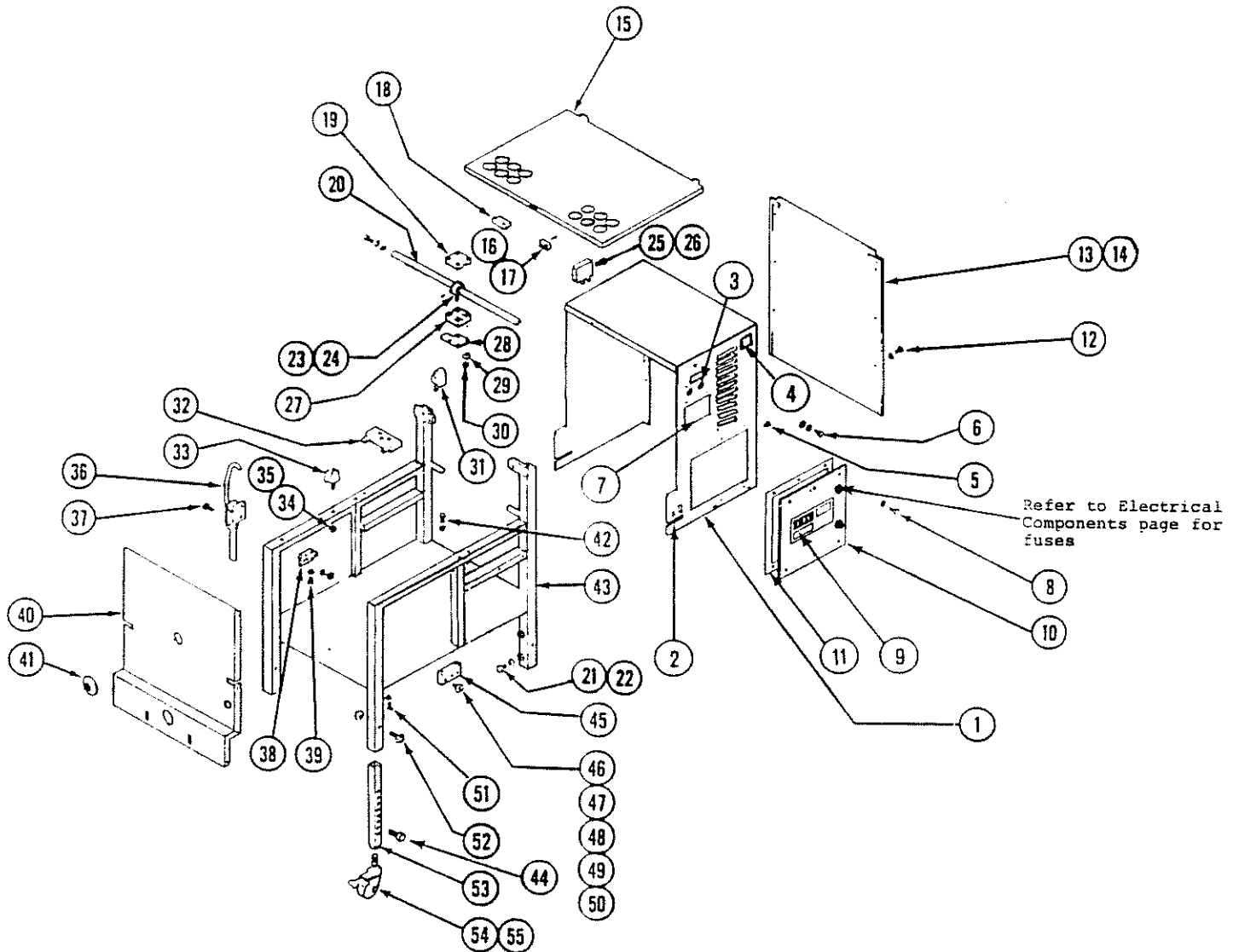

ITEM	QUANTITY	PART NO.	ITEM	QUANTITY	PART NO.
1 Panel, Main	1	150 9257	29 Washer, Spring	24	181 0615
2 Decal	1	150 9024	30 Nut	4	735 0056 93
3 Decal, Foot Switch	1	900 1002	31 Hinge	2	150 9228
4 Decal, Patent	1	150 9012	32 Block, Head Lock	1	150 3213
5 Rivnut	4	150 9274	33 Block, Position	2	150 9238
6 Bolt Assortment	2	150 9234	34 Nut	4	736 0051 40
7 Plate, Warning	2	900 0103	35 Lockwasher	4	756 0005 40
8 Bolt Assortment	22	150 3278	36 Clamp, Tub	1	150 9224
9 Name Plate	1	150 9221	37 Bolt Assortment	4	150 9268
10 Cover, Electrical Box	1	150 1300	38 Clamp, Tub	1	150 9223
11 Seal	2	150 3239	39 Bolt Assortment	2	150 0078
12 Bolt Assortment	4	150 9275	40 Panel, Front	1	150 9276
13 Panel	1	150 0067	41 Seal	1	150 0335
14 Decal, Warning	1	900 1038	42 Bolt Assortment	2	150 2525
15 Lid	1	150 9254	43 Frame	1	150 0062
16 Screw	2	713 1018 23	44 Plug	24	100 1271
17 Block, Lid Lock	1	150 3340	45 Block	1	150 9165
18 Handle	1	150 1030	46 Grease Fitting	3	2094
19 Block, Rear Friction	1	180 8053	47 Tube, Lube, Long	2	150 9167
20 Shaft	1	150 9341	48 Tube, Lube, Short	1	150 9168
21 Screw, Set	4	714 0536 99	49 Connector	3	150 1972
22 Acorn Nut	4	150 1041	50 Gormmet, Tube	1	150 9179
23 Actuator	1	150 9252	51 Bolt Assortment	1	150 0162
24 Screw, Set	1	714 0245 99	52 Bolt Assortment	4	100 0020
25 Lid Stop	1	150 9262	53 Leg, Standard	4	150 9390
26 Bolt Assortment	2	150 9266	54 Caster, Swivel	4	181 0500
27 Block, Front Friction	1	180 8054	55 Nut, Jam	4	580 2022
28 Plate, Clamp	1	180 8052			

