

INSTRUCTION MANUAL

with Catalog of Replacement Parts

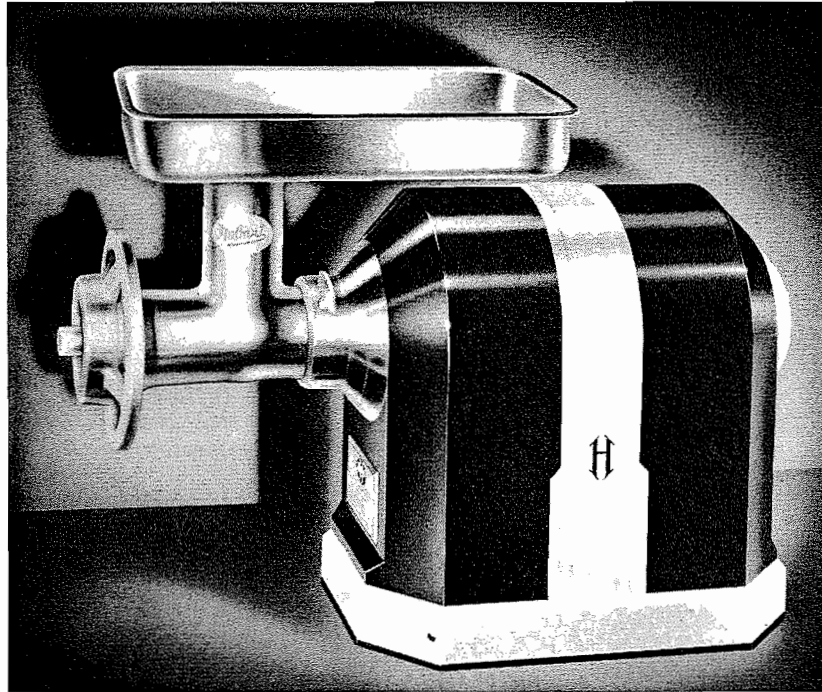

Model 4722 Chopper

SPECIFICATION 4845



THE HOBART MANUFACTURING COMPANY

TROY, OHIO, U. S. A.

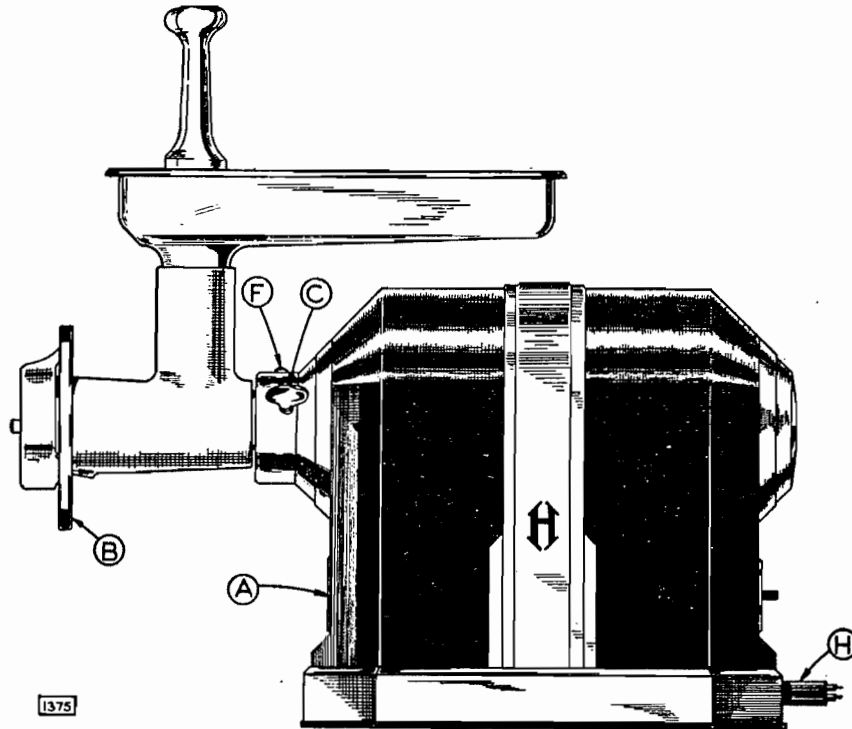

Instructions for Operation and Care of HOBART MODEL 4722 CHOPPER

INSTALLATION

Before making electrical connections, read the specifications on the name plate A and be sure that they agree with those of your electric service.

An outlet at H is tapped for $\frac{1}{2}$ " conduit, and connection can be made there, or if you prefer, the wires may be carried down through the bottom of the machine. For this purpose a knockout plug, K, is provided in the center of the removable bottom plate. See fig. 2. If the bottom outlet is used, a plug (See Page 4) may be ordered to close the opening at H. Do not connect into a lighting circuit but run a new line direct to the meter or service box and thus avoid overloading existing lines and fuses. Discard the short test wires that are attached to the switch when the machine is received and connect the line wires to the switch terminals. Both switch and bottom plate may be removed for convenience in wiring.

THE CHOPPER ATTACHMENT AND ITS CARE

New chopper attachments are given a coating for protection until the machine is installed. Before using, and after each day's use, take the attachment apart and give all the parts a thorough washing in warm soapsuds. Then rinse and dry. When re-assembling, apply a little tallow, suet, or lard to the fibre thrust washer on the

end of the worm and also a little on the shaft. The knife and plate likewise need some preliminary lubrication; rub tallow over them the first few times they are used.

When putting in the knife be sure to turn the cutting side toward the perforated plate and see that the notch on the rim of the plate fits over the pin in the bottom of the cylinder.

Do not pull up the adjusting wheel B too tight; if the knife and plate are both sharp, only a moderate pressure will be needed. When the chopper attachment is not in use, it may be kept in the refrigerator.

If your attachment is of Brite Metal, an occasional scouring with a mild scouring powder will keep it looking like new. Vinegar is good for removing meat stains.

INSERTING CHOPPER ATTACHMENT

When putting the chopper attachment on the machine, see that both the hub and the socket are clean. Insert with a slight twisting motion toward the left, so that the stop pin in the cylinder is in contact with the side of the hole that receives it. Then tighten the thumb screw C.

To remove the chopper attachment, loosen the screw C and give the attachment a twist to the right as you pull it out.

MEAT CHOPPING

Cut the meat into strips and pile it up in the feed pan. Then start the motor and feed the meat into the cylinder. If the strips are of proper size and are dropped in lengthwise, they will feed in without assistance from the feed stick, leaving both hands free to feed meat. Many actual tests have proven this method the fastest; nothing is gained by trying to force feeding with the feed stick. The fineness to which the meat is cut is governed by the size of the holes in the plate, not by the tension put upon the adjusting wheel. When cutting beef to a fine product, many butchers prefer the following method. The beef is first run through, using a plate with large holes. Seasoning may be added to the coarsely cut product if desired and then the meat is formed into small balls which will feed into the cylinder easily. A plate with $\frac{1}{8}$ " holes is used for recutting.

The feed pan should always be kept in place. It not only makes the regular feeding easy, but by holding the operator's fingers a safe distance away from the revolving worm, it insures maximum safety of operation.

LUBRICATION

A small can of clear, tasteless oil is furnished for lubricating the chopping attachment. Put a few drops in the oiler F every day.

The machine proper will not require oiling since the motor bearings and gear case are packed with lubricant sufficient to last for several years. To get at the filling plug it is necessary to remove the name plate A. Consult a Hobart Service man before adding grease.

CARE OF MOTOR

Single phase motors have commutators and brushes that require periodic dressing. We recommend that you have a Hobart Service man attend to this once a year.

To inspect the commutator, the rear half of the bakelite case must be removed as described below.

OPENING THE CASE

To take off the bakelite cover or case, lay the machine on its side and remove the bottom plate which is held by the four screws D, shown in fig. 2. Then take out the six screws E, turn the machine upright again and slip back the rear half of the case.

To take this part of the case off entirely, take off the switch plate and remove the screws that hold the switch to the case. The wires need not be detached from the switch, because the latter will pass through the opening in the case. To take off the half of the case at the chopper end, remove in addition to the screws E (fig. 2) the thumb screw C (fig. 1).

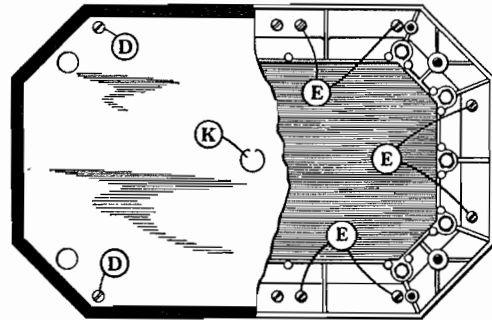

Fig. 2

Underneath view of the base with the bottom plate partially broken away. K is a knockout plug that may be broken out if a bottom outlet is desired.

If you wish further information or advice about your machine, feel free to call at our nearest agency or write to the factory.

THE HOBART MANUFACTURING CO.

TROY, OHIO U.S.A.

HOBERT REPLACEMENT PARTS

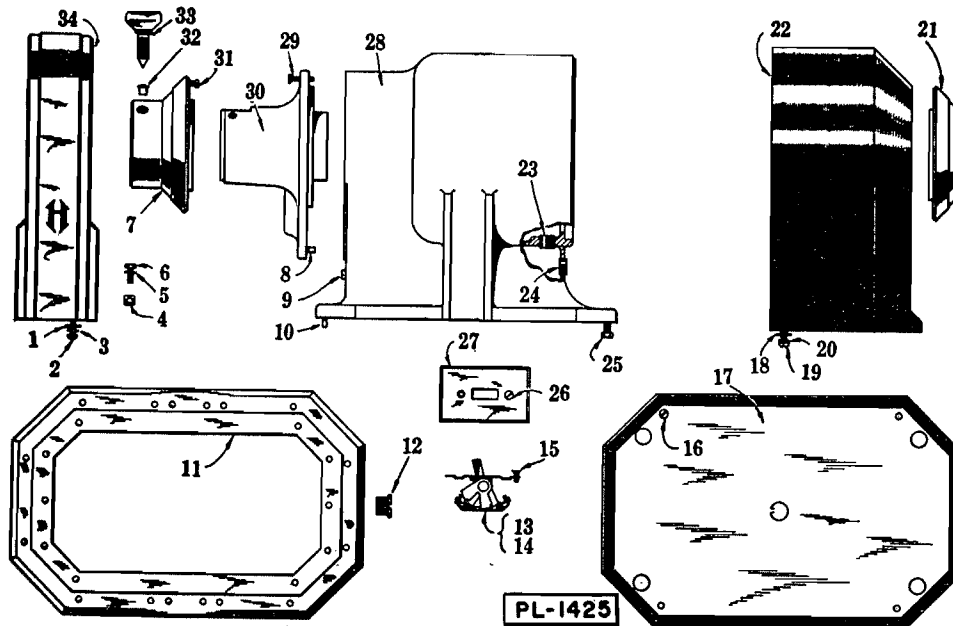

HOUSING AND SWITCH UNIT

ILLUS. PL-1425	PART NUMBER	NAME OF PART	AMOUNT
1	WS-3-1	Washer	4
2	SC-8-51	Mach. Screw - #12-24 x 3/4" Rd. Hd.	4
3	WL-3-28	Lock Washer - #12 x .062" x .047"	4
4	NS-8-8	Nut - 1/4"-20 (1/2" Sq.)	2
5	WL-3-36	Lock Washer - 1/4" x .107" x .047"	2
6	SC-36-6	Cap Screw - 1/4"-20 x 1" Hex Hd.	2
7	S-15145-1	Cap - Cover (Hub End)	1
8	P-11800-116	Dowel	1
9	V-15250-1	Plug - 1/4" Pipe (Special)	1
10	P-11800-116	Dowel	2
11	T-15149-1	Base - Sub	1
12	V-12632-2	Plug - Special	1
13	R-24940-4	Switch - 1 Phase & D.C. (Give Elec. Spec.)	1
14	R-24940-2	Switch - 3 Phase (Give Elec. Spec.)	1
15	SC-13-13	Mach. Screw - #6-32 x 5/16" Flat Hd.	2
16	SC-13-46	Mach. Screw - #10-24 x 1/2" Flat Hd.	4
17	S-15153	Cushion - Base	1
18	WS-3-1	Washer	12
19	SC-8-50	Mach. Screw - #12-24 x 5/8" Rd. Hd.	12
20	WL-3-28	Lock Washer - #12 x .062" x .047"	12
21	S-15146-1	Cap - Cover (Motor End)	1
22	T-15148	Housing (Bakelite)	2
23	V-6651	Bushing - Insulating (9/16" Lg.)	1
24	V-14046	Bushing - Insulating (5/16" Lg.)	2
25	SC-36-6	Cap Screw - 1/4"-20 x 1" Hex Hd.	8
26	SC-15-10	Mach. Screw - #6-32 x 3/8" Oval Ctsk. Hd.	2
27	M-23543	Plate - Switch	1
28	T-15106	Motor Frame & Gear Case	1
29	SC-13-71	Mach. Screw - #12-24 x 3/4" Flat Hd.	12
30	M-60374	Attachment Hub Sub-Assy (Incl. items #12 & 16 on Page 5)	1
31	V-6385	Screw - Special	12
32	OG-3-27	Oiler	1
33	M-14047-2	Thumb Screw - 1/2"-12	1
34	S-15147-1	Support - Housing	1

HOBART REPLACEMENT PARTS

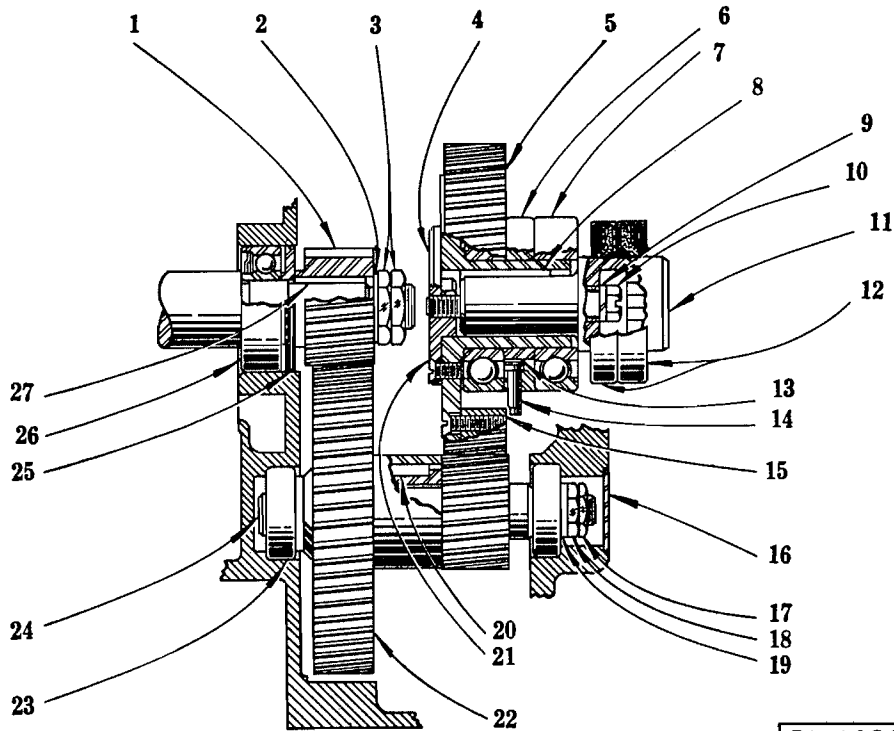

PL-1426

GEAR UNIT

ILLUS. PL-1426	PART NUMBER	NAME OF PART	AMOUNT
1	M-21783	Pinion - Motor (23T) -----	1
2	WS-11-1	Washer -----	1
3	V-9435	Lock Nut - Special -----	2
4	V-15257	Nut - Special -----	1
5	P-15325	Hub & Chopper Drive Gear Assy. -----	1
6	M-15260	Collar - Outer Spacing -----	1
7	BB-6-38	Ball Bearing - N.D. #3207 -----	2
8	R-12430-68	Key -----	1
9	WL-4-2	Lock Washer - 3/8" x .136" x .070" -----	1
10	SC-36-79	Cap Screw - 3/8"-24 x 2-3/4" Slotted Hex Hd. -----	1
11	M-15259	Sleeve - Square Drive -----	1
12	M-23618	Seal - Grease -----	2
13	V-15261	Collar - Inner Spacing -----	1
14	V-15262	Pin - Retaining (Spacer) -----	1
15	SC-13-72	Mach. Screw - #12-24 x 7/8" Flat Hd. -----	8
16	PL-3-31	Plug - 1-3/8" Expansion -----	1
17	V-4478	Lock Nut - Special -----	1
18	V-10928-2	Nut - Special -----	1
19	WS-8-4	Washer -----	1
20	R-12430-72	Key -----	1
21	SC-13-46	Mach. Screw - #10-24 x 1/2" Flat Hd. -----	3
22	P-21782	Counter Shaft Pinion & Main Drive Gear Assy. -----	1
23	BB-5-24	Ball Bearing - N.D. #3203 -----	2
24	P-15253	Shaft - Counter -----	1
25	M-15247	Deflector - Grease -----	1
26	BB-11-28	Ball Bearing - N.D. #C-8505 -----	1
27	R-12430-61	Key -----	1

HOBART REPLACEMENT PARTS

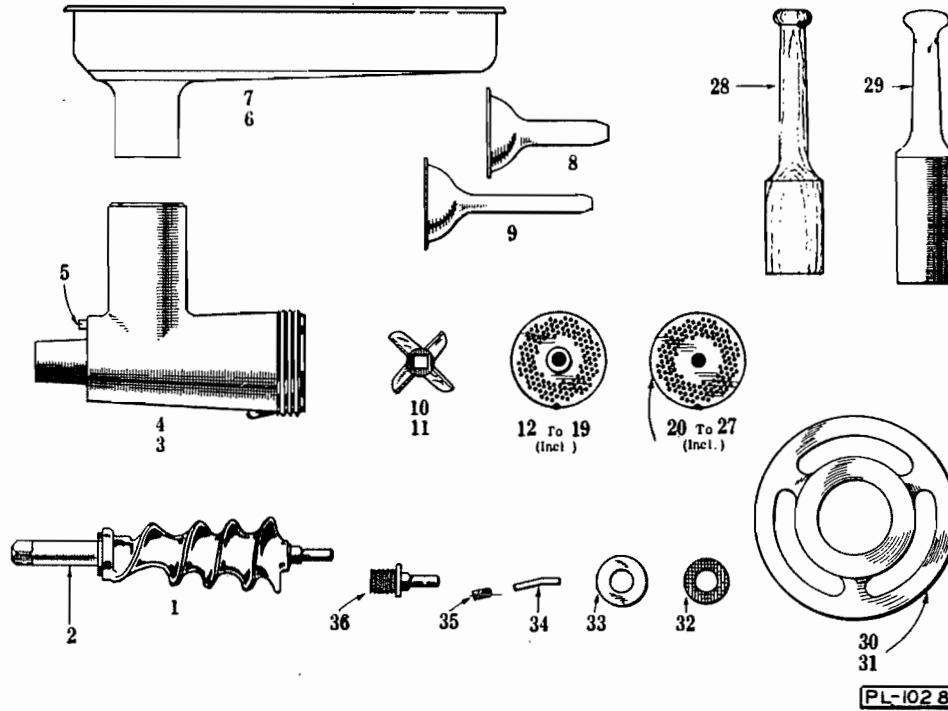

CHOPPER ATTACHMENT UNIT

ILLUS. PL-1028	PART NUMBER	DESCRIPTION	AMOUNT
1	M-15881	Worm Assy. (Incl. items #2, 32 & 36) -----	1
2	M-7201	Stud - Sq. Drive -----	1
3	M-24810	Chopper Cylinder Assy. Unit (Spiral Flute, Tinned) (Incl. items #5, 33, 34, 35) -----	1
4	M-24812	Chopper Cylinder Assy. Unit (Spiral Flute, Brite Metal (Incl. items #5, 33, 34, 35) -----	1
5	V-4035-1	Stud - Stop -----	1
6	S-21990-1	Pan - Feed (Tinned) -----	1
7	S-21990-2	Pan - Feed (Stainless St.) -----	1
8	M-5175	Stuffer - Sausage (Hog Casing) -----	1
9	P-5193	Stuffer - Sausage (Sheep Casing) -----	1
10	P-16409	Knife - Chopper (Drop Frg.) -----	1
11	P-60392	Knife - Chopper (Stay Sharp) -----	1
12	P-16430	Plate (Drop Frg.) (1/8" Dia. Holes) -----	1
13	P-16431	Plate (Drop Frg.) (3/16" Dia. Holes) -----	1
14	P-16432	Plate (Drop Frg.) (1/4" Dia. Holes) -----	1
15	P-16433	Plate (Drop Frg.) (3/8" Dia. Holes) -----	1
16	M-16434	Plate (Drop Frg.) (1/2" Dia. Holes) -----	1
17	M-16435	Plate (Drop Frg.) (5/8" Dia. Holes) -----	1
18	M-16436	Plate (Drop Frg.) (3/4" Dia. Holes) -----	1
19	M-16437	Plate (Drop Frg.) (15/16" Dia. Holes) -----	1
20	P-17521-3	Plate (Stay Sharp) (1/8" Dia. Holes) -----	1
21	P-17521-4	Plate (Stay Sharp) (3/16" Dia. Holes) -----	1
22	P-17521-5	Plate (Stay Sharp) (1/4" Dia. Holes) -----	1
23	P-17521-6	Plate (Stay Sharp) (3/8" Dia. Holes) -----	1
24	P-17521-7	Plate (Stay Sharp) (1/2" Dia. Holes) -----	1
25	P-17521-8	Plate (Stay Sharp) (5/8" Dia. Holes) -----	1
26	P-17521-9	Plate (Stay Sharp) (3/4" Dia. Holes) -----	1
27	P-17521-10	Plate (Stay Sharp) 15/16" Dia. Holes) -----	1
28	M-6555	Stick - Feed (Wood) -----	1
29	P-23150	Stick - Feed (Metal) -----	1
30	P-6391	Ring - Adjusting (Tinned) -----	1
31	P-13056	Ring - Adjusting (Brite Metal) -----	1
32	V-4221	Washer - Worm Thrust -----	1
33	V-4839-1	Washer - Cylinder Thrust -----	1
34	V-4036	Pin - Plate -----	1
35	V-4313	Screw - Plate Pin Retaining -----	1
36	M-15880	Stud - Plate -----	1