

MODEL	WxDxH	DOOR	SHELVES	H.P.	VOLT	WEIGHT
CVK48	48x35x50	2	3	1/3	115	490

**\*Remote unit price is not including any cooling system assembly parts. (Evaporator only)**  
**SPECIFICATIONS SUBJECT TO CHANGE WITHOUT NOTICE.**



## CVK48

### FEATURES AND BENEFITS

**\*Mechanically Controlled Uniform Temperature**

**\*Excellent Cooling Performance**

Over-sized condenser & evaporator coil keeping food fresh.

**\*CURVED thermo-pane glass front .**

thermo-pane glass sliding doors rear

**\*Welded Base Construction with a Choice of Formica Panel (additional colors available)**

**\*DRY UNIT – NOT WITH THERMO PANE GLASS AND NO ANY COOLING SYSTEM INCLUDED.**

Interior – aluminum sides and stainless steel floor

**\*Three Level Adjustable Up and Down Epoxy Wire Shelves**

**\*Independently wired Shelf Lights**

**\*Defrost Timer System**

By keeping cooling systems separate from the evaporator, it does not ice up or inhibit the compressor, giving the unit outstanding performance and a long life even in the most difficult environments

**\*The Famous American Brand**

“Tecumseh” Compressor

**\*Holds 37°F - 40°F**

**\*CVK models are designed to operate in an environment where temperature & humidity do not exceed 75°F and 65% relative humidity.**

**\*Self evaporated water from evaporator (Self-Contain System) No Plumbing Required**

**\*ETL listed**



**\*Exterior -Stainless steel and & sides formica panel**

**\*MEA City of New York Building Department Approved**

28

MODEL: CVK

FRONT VIEW

SIDE VIEW

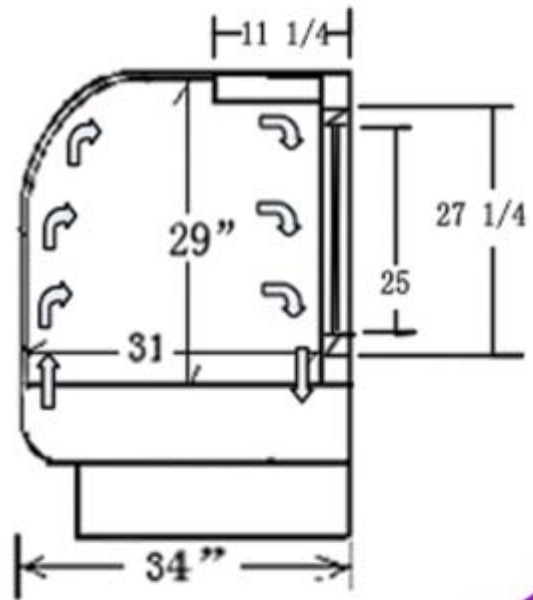
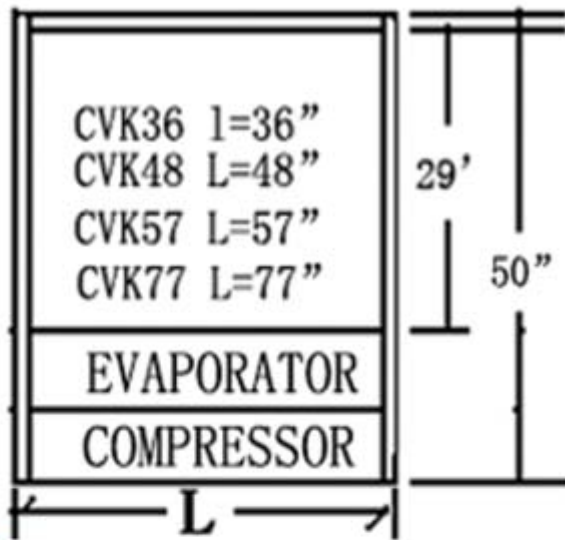

DIAGRAM

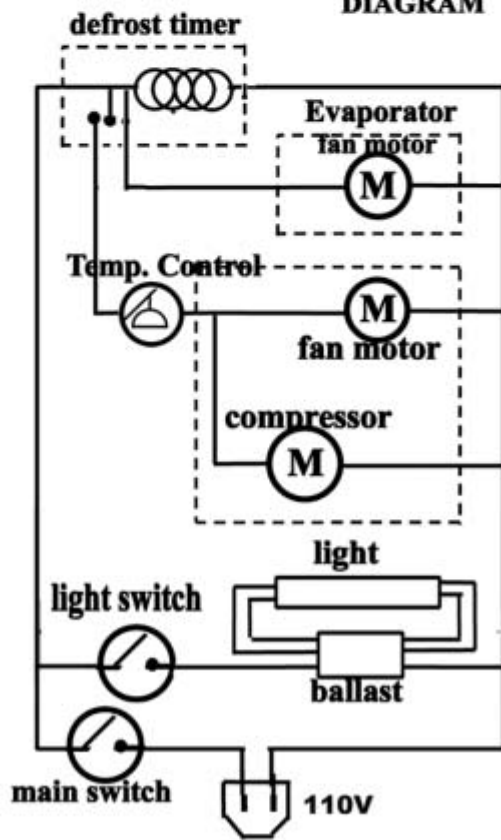

BEST QUALITY

BEST SERVICE

BEST VALUE

SINCE 1992