

MMP160VV

MMP190VV

MMP240VV

MMP190VV  
Combi

MMP 240VV  
Combi

- Power: Single phase.  
MMP 160VV: 220 Watts  
MMP 190VV: 250 Watts  
MMP 240VV: 270 Watts
- Variable speed: from 2000 to 12500 rpm
- Automatic speed self regulation system
- All stainless steel removable shaft on all three models and removable bell on MMP 190VV and MMP240VV for maximum sanitation.
- Reinforced coupling design for longer lifespan.
- Shaft length:  
MMP 160 VV - 7"  
MMP 190 VV - 8"  
MMP 240 VV - 12"  
Whisk length for Combi models: 7"
- 2 discs come standard with all models: one for cutting and one stirring.
- 1 Year "No Hassle" Replacement Warranty.
- ETL Electrical and Sanitation listed/CETL (Canada).

Mini size, Maxi Performance.  
Ideal for "sauces and small quantities"



Robot Coupe U.S.A., Inc.

P.O. Box 16625

Jackson, MS 39236-6625

1-800-824-1646 • (601) 898-8411

FAX: (601) 898-9134

www.robotcoupeusa.com • e-mail: info@robotcoupeusa.

## Specifications

**STANDARD MODEL:** Variable Speed Power Mixer with stainless steel mixer attachment with removable stainless steel knife, mixer blade, splash guard, wall mount and blade disassembly tool. Combi models include 7" whisk.

**ELECTRICAL REQUIREMENTS:** 120V, 60HZ, single phase

**SWITCHING:** "On/Off control button and variable speed control.

**MOTOR:**

MMP 160VV: 220 Watts

MMP 190VV: 250 Watts

MMP 240VV: 270 Watts

**SHIPPING WEIGHT:**

MMP 160VV: 5 lbs

MMP 190VV: 5 lbs

MMP 240VV: 5 lbs

**STANDARDS:** ETL electrical & sanitation, cETL (Canada)

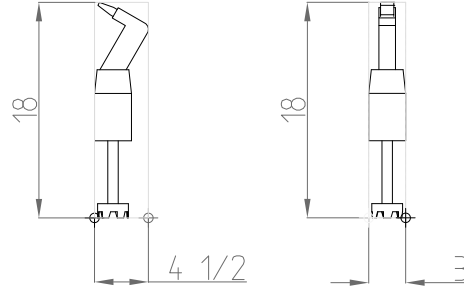

**MMP160VV**

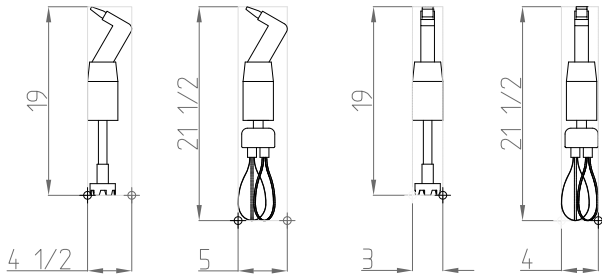
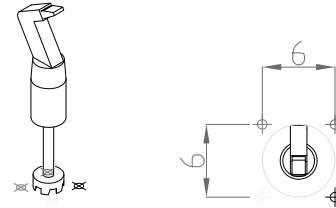

**MMP190VV & MMP190VV Combi**

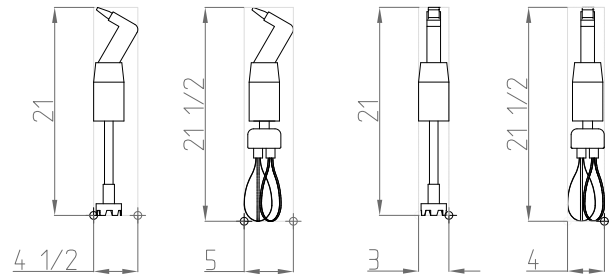

**MMP240VV & MMP240VV Combi**



Ref #121106

Robot Coupe U.S.A., Inc.  
 P.O. Box 16625  
 Jackson, MS 39236-6625  
 1-800-824-1646  
 (601) 898-8411  
 FAX: (601) 898-9134  
 www.robotcoupeusa.com  
 e-mail: info@robotcoupeusa.com

**Distributed by:**